



**USED ON
GROVE**

USED ON GROVE



JOYSTICKS & CONTROL BOXES

ELECTRONIC JOYSTICKS



Dual-axis

REF [145TA3341](#)



Single-axis

REF [165TA3893](#)



Single-axis

REF [139TA5040](#)



Single-axis

Used on SM2646E, SM3146E

REF [151TA1110](#)



Single-axis

Used on AMZ39NE, AMZ39NEU

REF [151TA1111](#)



Single-axis

REF [151TA1114](#)



Single-axis, with centre lock

REF [151TA1116](#)



Single-axis

Used on AMZ68XT

REF [145TA2867](#)



Single-axis

Used on A45J

REF [145TA3099](#)



Single-axis

Used on AMZ68XT

REF [145TA2877](#)

USED ON GROVE



ELECTRONIC JOYSTICKS

JOYSTICKS & CONTROL BOXES



Single-axis

REF [145TA3339](#)



Single-axis

Used on A45J, MZ72DXTU

REF [145TA3096](#)



Single-axis

REF [145TA3338](#)



Single-axis

REF [151TA1113](#)



Single-axis

Used on AMZ50XT

REF [145TA3106](#)



Single-axis

REF [151TA1117](#)



Single-axis

Used on Toucan 800, 800A

REF [165TA3894](#)



Dual-axis

Used on SM3884XT

REF [151TA1109](#)



Single-axis

Used on MZ72DXTU

REF [145TA3109](#)

USED ON GROVE



CONTROLLERS & PRINTED CIRCUIT BOARDS

MOTOR CONTROLLER



- Voltage: 48 V
- Current: 400 A

Used on Toucan 800A, 910

REF [165TA3895](#)

PRINTED CIRCUIT BOARDS

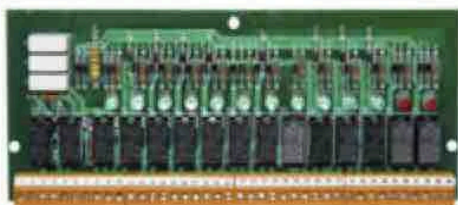

Board relay

Used on AMZ68XT, A45J, MZ72DXTU



Board-tach

Used on AMZ39NE, AMZ39NEU



Connectors board

Used on Toucan 910

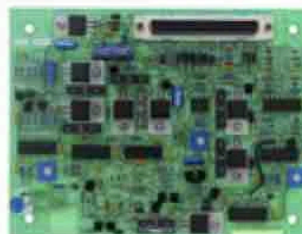

Delay timer board

Used on Toucan 910



Electronic board

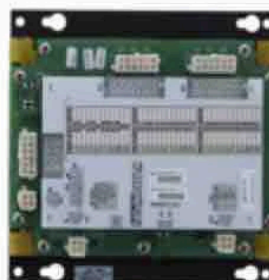

Printed circuit board

USED ON GROVE



PRINTED CIRCUIT BOARDS

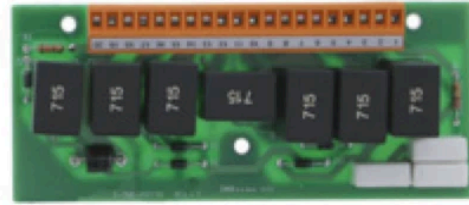
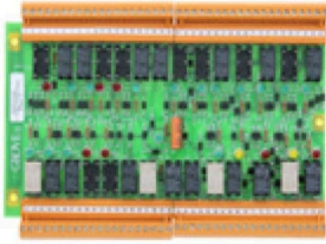

Used on SM2632E



UCB board T800/VM2639E

Used on Toucan 800A

Although these electronic cards may resemble the one fitted on your mobile elevating work platform there can be a big difference. Therefore we always ask you to supply us with part number or full vehicle details before ordering a similar unit.

This is just a small selection of our electronic boards. For all other types, please feel free to call us!

CONTROLLERS & PRINTED CIRCUIT BOARDS

USED ON GROVE



ELECTRICAL PARTS

AUTOMATIC FUSE



- Type of fuse: with push button
- Voltage: 50 VDC/250 VAC
- Current: 30 A

REF [141TA3599](#)

ELECTRIC BRAKE



- Voltage: 24 V
- Power: 31 W
- Outer diameter coil: 125 mm
- Outer diameter: 165 mm
- Number of teeth: 13

REF [136TA2840](#)

BUZZERS/BACK-UP ALARMS



- Voltage: 1-16 V
- Volume: 93 dB
- Conformity: not approved

Used on AMZ68XT, AMZ106XT, SM3884XT, AMZ50XT, A45J, MZ72DXTU

REF [150TA9930](#)



- Voltage: 12-24 V
- Volume: 102 dB
- Conformity: SAE-approved

Used on AMZ68XT, AMZ106XT, SM3884XT, SM4688XT, A45J

REF [150TA9928](#)

CABLE GLAND



- 90°
- PG29

Used on Toucan 800, 800A, 910

REF [151TA1212](#)

CONTACT KIT

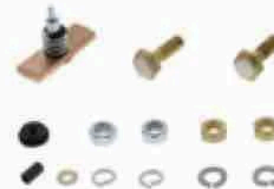

- Number of contacts: 3
- Diameter largest tip: 10,3 mm
- Number of tips: 4

REF [108TA8231](#)

USED ON GROVE



CONTACTORS COMPLETE						
	Voltage V	Maximum current interrupted A	Maximum current uninterrupted A	Magnetic blowouts	Dust cover	REF
	12	100	100	No	Enclosed version	165TA3896
	24	100	100	No	IPP66	165TA3897
	24	100	100	No	No	139TA5069
	24	150	150	Yes	Yes	165TA3898
	24	150	200	No	No	107TA1281
	24	300	300	No	Enclosed version	125TA4562

ELECTRICAL PARTS

USED ON GROVE



ELECTRICAL PARTS

CONNECTOR HOUSINGS



- Biggest diameter: 47,5 mm
- Smallest diameter: 31,5 mm
- Height: 65 mm
- Number of pins: 23

Used on AMZ39NE, AMZ39NEU, AMZ68XT, AMZ106XT, AMZ739NE, A45J, MZ72DXTU

REF [151TA1144](#)



- Biggest diameter: 48 mm
- Smallest diameter: 33 mm
- Height: 40 mm
- Number of pins: 26

Used on Toucan 910, 800A

REF [151TA1152](#)



- Biggest diameter: 49,32 mm
- Smallest diameter: 40,77 mm
- Height: 65,28 mm
- Number of pins: 23

Used on AMZ68XT, AMZ106XT, T86J, SM3384XT, A45J, MZ72DXTU

REF [165TA3899](#)

RELAYS



- Type of relay: printed circuit board
- Voltage: 12 V
- Type of voltage: DC
- Current: 5 A

Used on AMZ68XT, AMZ106XT, A45J, MZ72DXTU

REF [151TA1313](#)



- Type of relay: printed circuit board
- Voltage: 12 V
- Type of voltage: DC
- Current: 5 A

Used on AMZ68XT, AMZ106XT, A45J, MZ72DXTU

REF [165TA3900](#)

USED ON GROVE



TIMER RELAYS



- For 12 V-machines
- 5 sec

Used on AMZ68XT, A45J,
MZ72DXTU

REF [151TA1305](#)



- For 12 V-machines
- 15 sec

Used on AMZ68XT, A45J,
MZ72DXTU

REF [151TA1312](#)



- For 12 V-machines
- 0,5 sec

Used on AMZ68XT, AMZ106XT,
A45J, MZ72DXTU

REF [151TA1318](#)

SERVO MOTOR



Voltage: 24 V

REF [139TA5038](#)

BREATHER



- Type of thread: 1/4" BSP RH
- Maximum diameter: 44,5 mm
- Width across flats: 17 mm

Used on Toucan 1100, 1100C

REF [139TA5186](#)

BRUSH KIT



- Thickness: 7,8 mm
- Width: 27,8 mm
- Height: 30,5 mm
- Set of 4 brushes

Used on Toucan 800, 800A, 910,
1100, 1100C

REF [121TA2443](#)

USED ON GROVE



ELECTRICAL PARTS

CARBON BRUSHES



- Thickness: 9,3 mm
- Width: 20,4 mm
- Height: 29 mm

Used on SM3248E

REF [140TA4715](#)



- Thickness: 9,4 mm
- Width: 20,6 mm
- Height: 28 mm

Used on AMZ39NE/AMZ39NEU, AMZ739NE

REF [122TA5244](#)

ELECTRIC MOTORS

	Minimum voltage	Current	Revolutions/minute	Power	Direction of rotation	REF
	V	A	rpm	kW		
	12	220	2500	1,6	CCW	139TA5037
	24	150	3600	2,94	CW	122TA7771
	24	162	3600	3,07	CCW	150TA9957
	48	82	2650	3,12		150TA9956
	48	94	2850	3,38		150TA9961
	50	133	3300	5,22		150TA9960

USED ON GROVE



GEARS



- Outer diameter: 103,4 mm
- Total height: 78,5 mm
- Number of teeth: 19
- Number of splines: 23

Used on AMZ68XT, MZ72DXTU

REF [165TA3901](#)



- Outer diameter: 87 mm
- Total height: 252 mm
- Number of teeth: 19

Used on Toucan 1100, 1100C

REF [165TA3902](#)

ELECTRICAL PARTS

DISC FOR ELECTRIC BRAKE



- Type: friction disc
- Outer diameter: 97 mm
- Number of splines: 25

Used on AMZ39NE,
AMZ39NEU, AMZ739NE

REF [150TA9965](#)

FRICTION PLATE



- Type of friction plate:
different shape
- External diameter: 98 mm
- Internal diameter: 60 mm

Used on AMZ39NE,
AMZ39NEU, AMZ739NE

REF [150TA9964](#)

USED ON GROVE



SWITCHES

CONTACT BLOCKS



- Voltage AC: 230 V
- Current AC: 2 A
- Voltage DC: 200 V
- Current DC: 1 A

REF [147TA1651](#)



- Voltage: 600 V
- Current: 10 A
- 1 x NC contact

Used on Toucan 800, 800A, 910, 1100, 1100C

REF [165TA3903](#)

CONTACT BLOCK HOLDER



Dimensions: 15,8 x 30 x 46,5 mm

Used on AMZ39NE/AMZ39NEU, AMZ68XT, SM2632E, AMZ739NE, SM3884XT, A45J, MZ72DXTU, AMZ106XT

REF [138TA7184](#)

EMERGENCY STOP SWITCH HIGH CAPACITY



- Maximum contact voltage: 80 V
- Current: 300 A
- Magnetic blowouts: no
- Dust cover: enclosed

Used on A45J, MZ72DXTU

REF [139TA2682](#)

FOOT SWITCH



- Voltage: 240 V
- Current: 3 A
- IP66
- Number of NC contacts: 2
- Number of NO contacts: 2

Used on AMZ68XT, AMZ106XT, A45J, MZ72DXTU

REF [150TA9843](#)

IGNITION SWITCH



- Number of connections: 4
- Number of positions: 4
- Built-in diameter: 19 mm
- Total length: 71 mm

Used on SM2646E/SM3146E, AMZ39NE/AMZ39NEU, SM2632E, AMZ66, AMZ2739NE, SM4688XT, SM3884XT, AMZ50XT

REF [164TA7398](#)

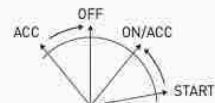

IGNITION SWITCH KEY



- Key number: 421E
- Number of supplied keys: 1

REF [129TA4269](#)

USED ON GROVE



SWITCHES

LIMIT SWITCHES



- Number of NO contacts: 0
- Number of NC contacts: 2
- Current: 6 A

Used on Toucan 800, 800A, 910, 1100, 1100C

REF [139TA5077](#)



- Number of NO contacts: 1
- Number of NC contacts: 1
- Current: 3 A

Used on AMZ106XT, AMZ68XT, SM3248E, SM4688XT, SM3884XT

REF [146TA8583](#)



- Number of NO contacts: 1
- Number of NC contacts: 1
- Current: 3 A

Used on T86J, A45J, MZ72DXTU

REF [146TA8584](#)

MICROSWITCH



- Number of connections: 3
- Number of CO contacts: 1
- Current: 5 A

Used on Toucan 800, 800A, 910, 1100, 1100C

REF [139TA5078](#)

MUSHROOMHEAD PUSH BUTTONS



Diameter: 40 mm

Used on Toucan 800, 800A, 910

REF [165TA3904](#)



- Diameter: 40 mm
- 1 x NC contact

Used on A45J, MZ72DXTU

REF [165TA3905](#)

USED ON GROVE



SWITCHES

OPERATING HEAD



- Number of positions: 3
- Built-in diameter: 22 mm
- Key number: 421E
- Material: metal

Used on SM2646E, SM3146E, SM3160E, SM2632E, SM3884XT, AMZ68XT, AMZ106XT, AMZ66, AMZ50XT, A45J, MZ72DXTU

REF [139TA5090](#)

Spare part key



REF [129TA4269](#)

PUSH BUTTON COMPLETE



- Diameter: 16 mm
- Length: 42,5 mm
- Button colour: black

Used on SM2646E, SM3146E, SM3160E, SM2632E, SM3884XT, AMZ68XT, AMZ106XT, AMZ66, AMZ50XT, AMZ2739NE, A45J, MZ72DXTU

REF [146TA9929](#)

ROTARY SWITCH



- Number of positions: 3
- Voltage: 600 V
- Current: 10 A
- Built-in diameter: 22 mm

Used on Toucan 800, 800A, 910, 1100, 1100C

REF [139TA5105](#)

RUBBER BELLOWS SWITCHES



Height: 11 mm

Used on SM2646E, SM3146E, SM3160E, SM2632E, SM3884XT, SM3248E, AMZ68XT, AMZ106XT, AMZ39NE/AMZ39NEU, AMZ66, AMZ50XT, AMZ2739NE, A45J, MZ72DXTU, T86J

REF [127TA2723](#)



Height: 19 mm

Used on SM2646E, SM3146E, SM3160E, SM2632E, SM3884XT, AMZ68XT, AMZ106XT, AMZ2739NE, A45J, MZ72DXTU

REF [165TA3906](#)



Height: 24,5 mm

Used on Toucan 800, 800A, 910

REF [139TA5088](#)

USED ON GROVE



TOGGLE SWITCHES

SWITCHES



- Positions: on-off-on
- Number of connections: 3
- Voltage: 125 – 250 – 277 V
- Current: 10 A

Used on AMZ66, AMZ50XT

REF [126TA5385](#)

- Positions: on-off-on
- Number of connections: 6
- Voltage: 125 – 250 – 277 VAC
- Current: 10 A

Used on AMZ39NE/AMZ39NEU, AMZ68XT, AMZ106XT, AMZ66, AMZ739NE, AMZ50XT, A45J, MZ72DXTU

REF [126TA5388](#)

- Positions: on-off-on
- Number of connections: 6
- Voltage: 125 – 250 V
- Current: 6 A

Used on Toucan 910

REF [139TA5087](#)

- Positions: on-on
- Number of connections: 3
- Voltage: 125 – 250 – 277 VAC
- Current: 15 A

Used on SM2646E, SM3146E, SM3160E, SM3384XT, SM3248E, AMZ68XT, AMZ106XT, AMZ66, AMZ50XT, A45J, MZ72DXTU

REF [146TA8573](#)

- Positions: on-on-on
- Number of connections: 6
- Voltage: 250 VAC
- Current: 9 A

Used on AMZ68XT, AMZ106XT

REF [146TA5683](#)

- Positions: on-on-on
- Number of connections: 6
- Voltage: 277 VAC, 250 VDC
- Current: 15–20 A

Used on A45J, MZ72DXTU

REF [147TA1661](#)

USED ON GROVE



SENSORS

TILT SENSORS



- Dimensions: 97 x 89 x 1155 mm
- Switch type: normally closed
- Voltage: 12-24 V
- Detection: 2,5° 2-sec delay

Used on SM3248E, A45J

REF [160TA5621](#)



- Dimensions: 97 x 89 x 116 mm
- Switch type: normally closed
- Voltage: 24 V
- Detection: 3°

Used on Toucan 910, 1100, 1100C

REF [139TA5064](#)



- Dimensions: diameter 84,5 x 63 mm
- Switch type: normally closed
- Voltage: 24 V
- Detection: 1,9°/1,9° (X/Y)

REF [139TA5059](#)



- Height: 113 mm
- Diameter: 45 mm
- Switch type: normally closed
- Voltage: 12-24 V
- Detection: 3° 2-sec delay

Used on T86J

REF [165TA3909](#)



- Height: 113,5 mm
- Diameter: 89 mm
- Voltage: 24 V
- Detection: 4,5° 2-sec delay

Used on AMZ50XT, AMZ106XT, SM2632E

REF [165TA3907](#)



- Height: 120 mm
- Diameter: 97 mm
- Switch type: normally closed
- Voltage: 12-24 V
- Detection: 4,5° 2-sec delay

Used on AMZ68XT

REF [165TA3910](#)

PROXIMITY SENSOR



- Height: 70 mm
- Diameter: M30 x 1,5 mm
- Switch type: inductive sensor NO/NC
- Voltage: 10/30 V

Used on MZ72DXTU

REF [165TA3908](#)

USED ON GROVE



COMBINATION GAUGES



Voltage: 24-48 V
Used on Toucan 910

REF [151TA1288](#)



- Voltage: 24-48 V
- Built-in diameter: 52 mm
- With lift lock-out
- Connection: with 8-pin connector

Used on Toucan 800, 800A, 1100, 1100C

REF [106TA1141](#)

INDICATORS & HOUR METERS

USED ON GROVE



HYDRAULIC PARTS

ACCUMULATOR



- Nominal volume: 176 l
- Permissible operating pressure: 206,75 bar
- Oil port: 9/16" UNF
- Precharge pressure: 43,4 bar
- Max outer diameter: 60,5 mm
- Material: steel

Used on AMZ68XT, AMZ106XT, SM4688XT, SM3884XT, A45J

REF [150TA9844](#)

AIR BRAKE VALVE



3-way valve without pedal acces

REF [165TA3913](#)

CARTRIDGE VALVES



- Width across flats: 19,05 mm
- Length: 103,3 mm
- Diameter: 16 mm

REF [165TA3911](#)



- Width across flats: 48 mm
- Length: 126 mm
- 3/8" cartridge holding valve

Used on AMZ66

REF [165TA3914](#)

CARTRIDGE WITH COIL

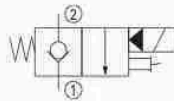

- Voltage: 12 V
- AC/DC: DC
- Resistance: 8,5 Ω
- Diameter: 15 mm
- Length: 112 mm

REF [165TA3912](#)

Cartridges exist in a variety of dimensions and wiring diagrams. When placing an order, always provide the necessary info with regard to the wiring diagram, as cartridges may have identical dimensions yet be connected in different ways.

Diameter D1 is the nose of the cartridge. Diameter D2 is the diameter of the cartridge end on which the coil is mounted.

USED ON GROVE



CARTRIDGE VALVE COILS



- Voltage: 12 V
- AC/DC: DC
- Resistance: 6,2 Ω
- Diameter: 45,3 mm
- Height: 58 mm

Used on SM4688XT, SM3884XT

REF [131TA8349](#)



- Voltage: 12 V
- AC/DC: DC
- Resistance: 7,8 Ω
- Diameter: 43,7 mm
- Height: 51,5 mm

Used on AMZ68XT, AMZ106XT, AMZ50XT, SM3884XT, SM4688XT

REF [131TA8285](#)



- Voltage: 18 V
- AC/DC: DC
- Resistance: 10 Ω
- Diameter: 16,3 mm
- Height: 44,5 mm

Used on AMZ68XT, AMZ106XT

REF [165TA3915](#)



- Voltage: 24 V
- AC/DC: DC
- Resistance: 21 Ω
- Diameter: 36,3 mm
- Height: 50 mm

Used on Toucan 800, 800A, 910

REF [131TA8293](#)

FITTING FOR HYDRAULIC CIRCUIT



Fitting: 9/16" JIC-3/8" BSP

Used on Toucan 800, 800A, 910, 1100, 1100C

REF [160TA3162](#)

USED ON GROVE



HYDRAULIC PARTS

STEERING CYLINDERS



- Total measured length: 172,5 mm
- Diameter tube: 25,4 mm
- Diameter rod: 6,4 mm
- Piston shaft stroke: 50 mm

REF [151TA1262](#)



- Total measured length: 291 mm
- Diameter tube: 60 mm
- Diameter rod: 35 mm

Used on Toucan 1100, 1100C

REF [165TA3917](#)



- Total measured length: 345 mm
- Diameter tube: 60 mm
- Diameter rod: 30 mm
- Piston shaft stroke: 130 mm

REF [151TA1266](#)



- Total measured length: 390 mm
- Diameter tube: 48 mm
- Diameter rod: 19 mm
- Piston shaft stroke: 158 mm

Used on AMZ39NE/AMZ39NEU, AMZ739NE

REF [151TA1263](#)



- Total measured length: 645 mm
- Diameter tube: 60 mm
- Diameter rod: 30 mm

Used on Toucan 910

REF [165TA3916](#)

USED ON GROVE



HYDRAULIC PARTS

HYDRAULIC MOTORS

Type of flange

Type A

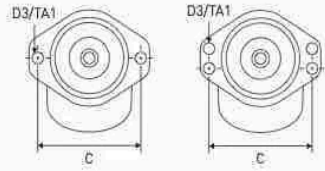

Type C

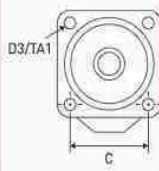

Type of shaft

Type C

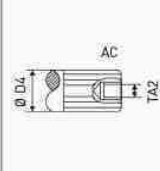

Type E

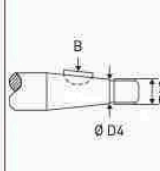

Type F

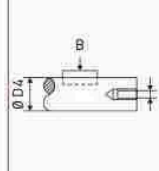

	Thread connections	Type of flange	Type of shaft	Total length mm	Used on	REF
	7/16" UNF x 20 Pi	S	E	317	SM3248E	165TA3918
	7/8" UNF x 14 Pi	A	F	223	A45J	151TA1086
	7/8" UNF x 14 Pi	C	E	270	Toucan 1100, 1100C	131TA6886
	5/16" UNC x 20 Pi	A	C	183,7	AMZ68XT, AMZ106XT, AMZ66, T86J, MZ72DXTU	151TA1087

HYDRAULIC PUMPS



- Total length: 142 mm
- Neck diameter: 45,2 mm
- Directory of rotation: CW
- Material of housing: metal

REF [151TA1097](#)



- Total length: 87,4 mm
- Neck diameter: 52 mm
- Directory of rotation: CCW
- Material of housing: aluminium

Used on Toucan 800, 800A, 1100, 1100C

REF [139TA5119](#)

USED ON GROVE



HYDRAULIC PARTS

HYDRAULIC PUMP GROUPS				
	Electric motor	Power kW	Used on	REF
	12 VDC	1,6	AMZ68XT, T86J	151TA1079
	24 V	3	Toucan 800, 800A, 1100, 1100C	139TA5117
	24 V	3	Toucan 910	105TA2721
	24 VDC	0,8	Toucan 800, 800A, 910	139TA5118

HYDRAULIC VALVE STD



- Number of elements: 1
- Number of plungers: 3
- Length: 172,5 mm

Used on Toucan 1100, 1100C

REF [165TA3919](#)

HAND PUMP LEVER



- Length: 334 mm
- Diameter: 27 mm

Used on Toucan 800, 800A, 910, 1100, 1100C

REF [165TA3920](#)

USED ON GROVE



HYDRAULIC PARTS

PART OF VALVE



- Cap
- Inner diameter: 19 mm
- Outer diameter: 24 mm

Used on Toucan 800, 800A, 910

REF [165TA3921](#)

ACTUATOR ASSEMBLY



Operating pressure: 3000 bar

Used on AMZ68XT, AMZ106XT

REF [151TA1103](#)

PNEUMATIC CYLINDER



- Outer diameter tube: 1"
- Diameter rod: 1/4"
- Stroke: 50 mm

Used on AMZ106XT, T86J, A45J, MZ72DXTU

REF [151TA1264](#)

PRESSURE VALVES (FLOW)



- Thread: M20 x 1,5 mm
- Length: 87 mm

Used on AMZ68XT, AMZ66

REF [165TA3922](#)



- Thread: M20 x 1,5 mm
- Length: 87 mm

Used on Toucan 800, 800A, 1100, 1100C

REF [164TA7704](#)



- Thread: 1 3/16"
- Length: 110 mm

Used on AMZ68XT, AMZ66, AMZ50XT

REF [165TA3923](#)

USED ON GROVE



ENGINE PARTS

SPRING SWIVEL



- Length: 73,5 mm
- Thread: 1/4" UNF

Used on T86J, A45J,
MZ72DXTU

REF [151TA1243](#)

ENGINE STOP SOLENOID



- Voltage: 12 V
- Type of current: DC
- Function: pull
- Mounting side: both sides
- Length: 96,3 mm

REF [165TA3925](#)

STARTER



- Voltage: 12 V
- Power: 2,9 kW
- Number of teeth: 10

REF [103TA3589](#)

V-BELT



- V-belt toothed open flank
- Belt width: 16,5 mm
- Belt height: 10,5 mm
- Outside length: 1225 mm

Used on T86J

REF [165TA3924](#)

USED ON GROVE



BALL JOINT



- Type of thread: inner
- Length: 33 mm
- Thread: 1/4" UNF
- Thread: RH

Used on AMZ106XT, T86J, A45J, MZ72DXTU

REF [151TA1329](#)

THRUST BEARINGS



Used on MZ72DXTU

REF [150TA9948](#)



Used on Toucan 910, 1100, 1100C

REF [165TA3927](#)

CABLE CLIP



- Length: 41,5 mm
- Width: 38 mm

Used on Toucan 800, 800A, 910, 1100, 1100C

REF [165TA3926](#)

CHAIN



- Pitch: 15,88 mm
- Plate combination: 4 x 4
- Pin diameter: 5,08 mm
- Total width: 16,4 mm

Used on Toucan 800, 800A, 910

REF [151TA1158](#)

USED ON GROVE



BODY & CHASSIS PARTS

CABLE GUIDES



- Outside dimensions: 106 x 50 mm
- Inside dimensions: 100 x 34 mm
- Material: plastic

Used on Toucan 1100, 1100C

REF [151TA1135](#)



- Outside dimensions: 116 x 50 mm
- Inside dimensions: 100 x 34 mm
- Material: plastic

Used on Toucan 1100, 1100C

REF [151TA1134](#)



- Outside dimensions: 85 x 32 mm
- Inside dimensions: 61,5 x 27 mm
- Material: plastic

Used on Toucan 910

REF [151TA1136](#)

MAST ROLLER ACCESSORY



- Total length: 111,5 mm
- Diameter roller: 80,6 mm
- Thread: M36 x 4 mm

Used on Toucan 800, 800A, 910, 1100, 1100C

REF [151TA1239](#)

MAST ROLLERS UPRIGHT



- Outer diameter: 113 mm
- Inner diameter: 28 mm
- Width outer ring: 55,5 mm

Used on Toucan 1100, 1100C

REF [165TA3928](#)



- Outer diameter: 114,5 mm
- Inner diameter: 50,5 mm
- Width outer ring: 47,5 mm

REF [140TA3087](#)

USED ON GROVE



RUBBER MOUNT



- Diameter: 16,5 mm
- Length: 19 mm
- Overall length: 64 mm

REF [165TA3929](#)

REDUCTOR



- Gear ratio: 40i
- Mounting position: B3
- Diameter input flange: 120 mm
- Diameter output flange: 210 mm
- Length: 235 mm

Used on Toucan 1100

REF [165TA3931](#)

BODY & CHASSIS PARTS

STEERING KNUCKLES



1



2

- Steering axle with hub, bearing and bolts
- 4 wheel bolts M16 x 1,5 mm
- Outside diameter hub: 170 mm
- King pin diameter: 40 mm
- Steering connection diameter: 20 mm

Used on Toucan 910

1. REF [151TA1206](#) - RH
2. REF [151TA1205](#) - LH

PULLEY MOUNT



- Number of holes: 6
- Material: metal

Used on Toucan 910

REF [165TA3930](#)

TIE ROD



- Length: 750 mm
- Diameter: 14 mm

Used on Toucan 800, 800A

REF [150TA9932](#)

USED ON GROVE



BODY & CHASSIS PARTS

STEERING AXLE ROD ENDS



- Type: tie rod end inner thread 1 bolt
- Thread type: 1 1/8" UNF
- RH/LH: RH
- Smallest diameter cone: 27,5 mm

Used on AMZ68XT, AMZ106XT, MZ72DXTU

REF [165TA3932](#)



- Type: tie rod end outer thread
- Thread type: 1 1/4" UNF
- RH/LH: LH
- Smallest diameter cone: 27,5 mm

Used on AMZ68XT, AMZ106XT, MZ72DXTU, T86J

REF [165TA3936](#)



- Type: tie rod end outer thread
- Thread type: 1 1/4" UNF
- RH/LH: RH
- Smallest diameter cone: 27,4 mm

Used on AMZ68XT, MZ72DXTU, T86J

REF [165TA3933](#)



- Type: tie rod end outer thread
- Thread type: 1 1/4" UNF
- RH/LH: RH
- Smallest diameter cone: 27,5 mm

Used on AMZ66

REF [165TA3937](#)



- Type: tie rod end outer thread
- Thread type: 1 1/4" UNF
- RH/LH: RH
- Smallest diameter cone: 27,5 mm

Used on AMZ106XT, AMZ68XT, MZ72DXTU, T86J

REF [165TA3934](#)

HOSE REEL SHEAVE



- Outer diameter roller: 95,2 mm
- Inner diameter ring: 34 mm
- Width roller: 35,6 mm

Used on Toucan 910

REF [165TA3935](#)

USED ON GROVE



WEAR PADS				
	Length mm	Material	Used on	REF
	101	Bronze	AMZ50XT	151TA1011
	152	Bronze	AMZ66	151TA1012
	102	Plastic		151TA1009
	91,8	Plastic	AMZ68XT, AMZ106XT, AMZ66	150TA9999
	153	Plastic	AMZ68XT, MZ72DXTU	150TA9997
	230	Plastic		151TA1000
	263	Plastic		150TA9989

BODY & CHASSIS PARTS

USED ON GROVE



COVERS & ACCESSORIES

DOOR HANDLES



- Length: 88 mm
- Grip range: 25-44 mm
- Knob operation

Used on Toucan 800, 800A, 910

REF [164TA7293](#)



- Length: 97 mm
- Width: 29 mm

Used on AMZ68XT, A45J, MZ72DXTU

REF [165TA3939](#)

ENGINE COVERS



- Length: 1740 mm
- Width: 510 mm
- Height: 585 mm

Used on Toucan 910

REF [165TA3938](#) - RH

REF [150TA9939](#) - LH

USED ON GROVE



COVERS & ACCESSORIES

PROTECTIVE COVERS



- Length: 1200 mm
- Width: 490 mm
- Height: 435 mm

Used on Toucan 1100, 1100C

REF [165TA3940](#)



- Length: 1365 mm
- Width: 490 mm
- Height: 490 mm

Used on Toucan 1100, 1100C

REF [150TA9937](#)



- Length: 220 mm
- Width: 153 mm
- Height: 21,5 mm

REF [165TA3941](#)



- Length: 224 mm
- Width: 153 mm
- Height: 21,5 mm

REF [165TA3943](#)



- Length: 393 mm
- Width: 246 mm

Used on Toucan 910

REF [165TA3942](#)

USED ON GROVE



DECALS

DECALS

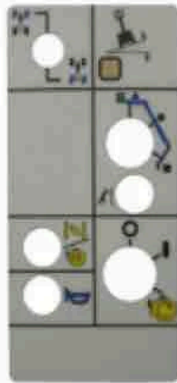

- Length: 114 mm
- Height: 238 mm

Used on AMZ68XT, A45J

REF [151TA1180](#)

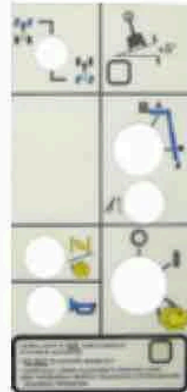

- Length: 115 mm
- Height: 237 mm

Used on MZ72DXTU

REF [138TA2366](#)

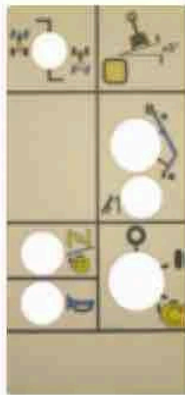

- Length: 115 mm
- Height: 238 mm

REF [138TA3172](#)

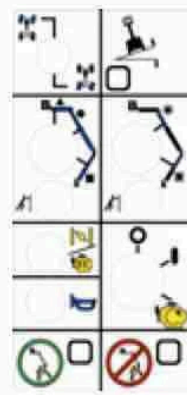

- Length: 117 mm
- Height: 238 mm

REF [151TA1183](#)

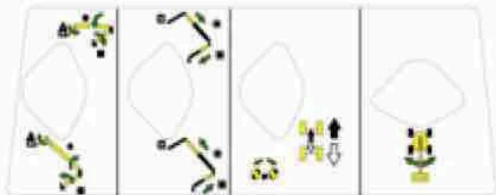

- Length: 366 mm
- Height: 136 mm

REF [151TA1184](#)

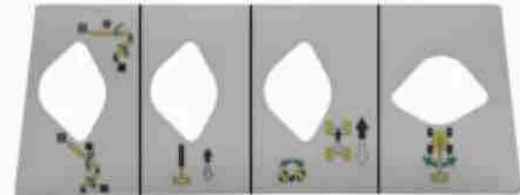

- Length: 367 mm
- Height: 135 mm

REF [138TA1862](#)

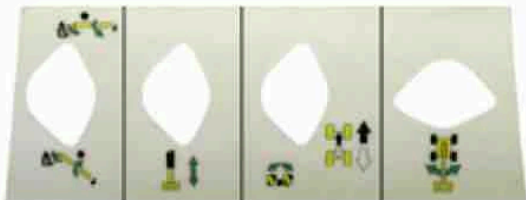

- Length: 367 mm
- Height: 136,5 mm

Used on MZ72DXTU

REF [151TA1174](#)

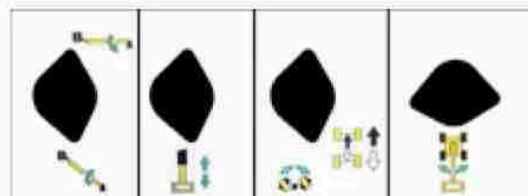

- Length: 368 mm
- Height: 132 mm

REF [151TA1181](#)

USED ON GROVE



DECALS

DECALS

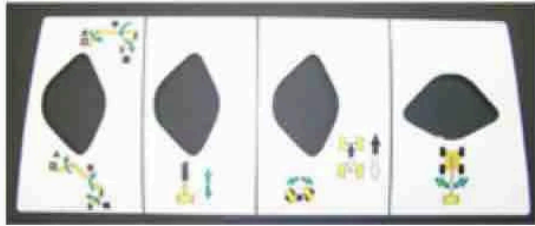

- Length: 370 mm
- Height: 136 mm

Used on AMZ68XT, A45J

REF 151TA1172

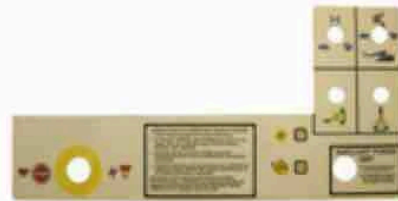

- Length: 498 mm
- Height: 238 mm

Used on AMZ68XT, A45J

REF 123TA5046

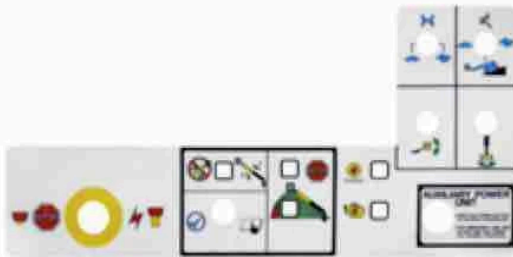

- Length: 500 mm
- Height: 238 mm

REF 162TA8802



- Length: 56 mm
- Height: 147 mm

Used on Toucan 800, 800A, 910

REF 151TA1170

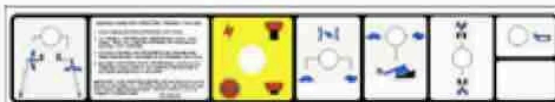

- Length: 576 mm
- Height: 90 mm

REF 151TA1179

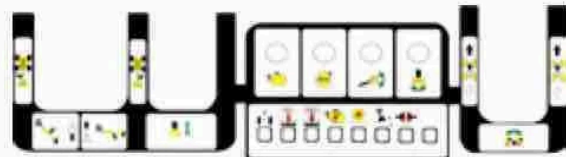

- Length: 588 mm
- Height: 160 mm

REF 151TA1182



- Length: 590 mm
- Height: 145 mm

REF 151TA1177



- Length: 685 mm
- Height: 75 mm

Used on AMZ39NE/AMZ39NEU, AMZ739NE, A45J

REF 138TA2963

USED ON GROVE



WHEELS, TYRES & RUBBER TRACKS

LOAD WHEEL



- Diameter wheel: 125 mm
- Width wheel: 50 mm
- Diameter shaft: 20 mm
- Material: rubber

REF [151TA2896](#)

SOLID TYRE



- Dimensions tyre: 400 x 8
- Non-marking

Used on SM2632E

REF [142TA3484](#)

For more information, contact your sales advisor.

SOLID TYRE KITS



Diameter: 360 mm

Used on SM2632E

REF [165TA3944](#)



Diameter: 360 mm

Used on SM2632E

REF [165TA3945](#)



Diameter: 360 mm

Used on Toucan 910, 1100, 1100C

REF [150TA9904](#)



Diameter: 410 mm

Used on Toucan 800, 800A

REF [165TA3946](#)

For more information, contact your sales advisor.

USED ON GROVE



TRACTION WHEELS



- Diameter wheel: 406 mm
- Number of bolt holes: 4
- Width wheel: 126 mm
- Diameter shaft: 85 mm

Used on Toucan 910, 1100, 1100C

REF [165TA3947](#)



- Diameter wheel: 406 mm
- Number of bolt holes: 4
- Width wheel: 127 mm
- Diameter shaft: 28 mm

Used on Toucan 1100, 1100C

REF [145TA9141](#)



- Diameter wheel: 406 mm
- Number of bolt holes: 5
- Width wheel: 127 mm
- Diameter shaft: 95 mm

Used on Toucan 910

REF [150TA9897](#)



- Diameter wheel: 406 mm
- Number of bolt holes: 5
- Width wheel: 127 mm
- Diameter shaft: 95 mm

Used on Toucan 910

REF [165TA3950](#)



- Diameter wheel: 660 mm
- Number of bolt holes: 6
- Width wheel: 200 mm
- Diameter shaft: 162 mm

Used on AMZ39NE/AMZ39NEU, AMZ739NE

REF [165TA3948](#)

WHEEL BOLT



- Neck diameter: 22,1 mm
- Length: 64 mm
- Thread type: 3/4" UNF
- Imperial pitch: 16 Pi
- RH/LH: RH

Used on AMZ68XT, MZ72DXTU

REF [165TA3949](#)

USED ON GROVE



HARDWARE

AXLES/PINS					
	Diameter mm	Total length mm	Hardened	Used on	REF
	10	87,5	No	AMZ39NE/AMZ39NEU, AMZ739NE, SM3248E, A45J	151TA1037
	12	72	No	Toucan 1100, 1100C	150TA9874
	25	120	No	Toucan 800, 800A, 1100, 1100C	165TA3951
	25	252	No	Toucan 1100, 1100C	150TA9870
	25	78	No	Toucan 800, 800A, 1100, 1100C	150TA9873

SPECIAL BOLT



- Thread: M8
- Length: 20 mm
- Diameter: 1,25 mm

Used on Toucan 800, 800A, 910, 1100, 1100C

REF [151TA1021](#)

USED ON GROVE



LOCKING PINS



- Diameter pin: 9,5 mm
- Total length: 505 mm
- Length tether: 210 mm

Used on SM2646E/SM3146E/
SM3160E, SM3248E, SM4688XT

REF [165TA3952](#)



- Width across flats: 17 mm
- Thread: M16 x 1,5 mm

REF [165TA3954](#)

HARDWARE

PRESSURE SPRING



- Outer diameter: 30,8 mm
- Length: 64 mm

Used on SM2632E

REF [165TA3953](#)

USED ON GROVE



NOTES

A large area of horizontal dotted lines for taking notes.