

# ALTERNATORS



For all our latest catalogue updates and company info: [www.tvh.com](http://www.tvh.com)

used for: **SALEV**

ALTERNATORS

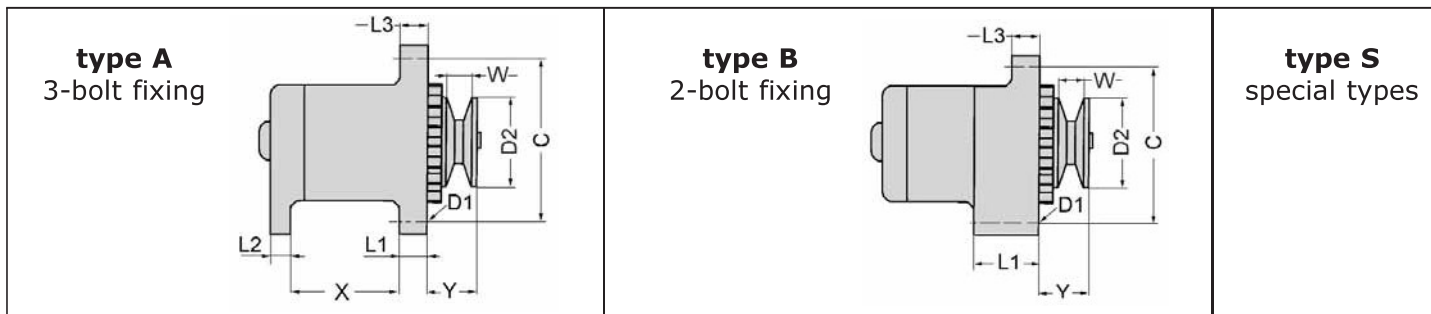

voltage (volt)	type	dimension (mm)	dimension (mm)	dimension (mm)	dimension (mm)	dimension (mm)	dimension (mm)	dimension (mm)	dimension (mm)	dimension (mm)	regulator	reference new
U	TY	X	L1	L2	L3	Y	D2	W	C	REG		
12	A	98	13	10	13,5	41	82	12	158	V	<a href="#">135TA1717</a>	



# ALTERNATORS

For all our latest catalogue updates and company info: [www.tvh.com](http://www.tvh.com)

ALTERNATORS

used for: **SAMBRON**

**type A**  
3-bolt fixing

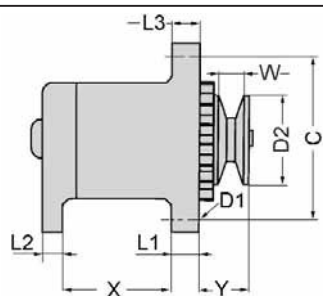

**type B**  
2-bolt fixing

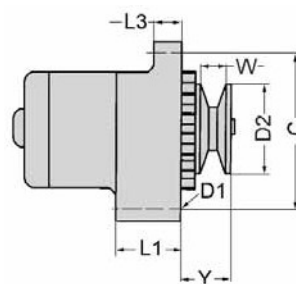

**type S**  
special types

voltage (volt)	type	dimension (mm)	dimension (mm)	dimension (mm)	dimension (mm)	dimension (mm)	dimension (mm)	dimension (mm)	dimension (mm)	regulator	reference new
U	TY	X	L1	L2	L3	Y	D2	W	C	REG	
12	A	83,5	12	12	12,4	33	63,8	12	148	V	<a href="#">128TA3795</a>
	B		16,6		14,2	51,5	65	14	132		<a href="#">124TA6654</a>
	B		56		10				144	V	<a href="#">124TA6628</a>
	B		56		16,5				173	V	<a href="#">124TA6615</a>
	B		56		56				156	V	<a href="#">135TA1875</a>
24	A	82	14	14	14				159,6	V	<a href="#">124TA6655</a>



REF [128TA3795](#)



REF [124TA6654](#)



REF [124TA6628](#)



REF [124TA6615](#)



REF [135TA1875](#)



REF [124TA6655](#)





# ALTERNATORS

For all our latest catalogue updates and company info: [www.tvh.com](http://www.tvh.com)

ALTERNATORS

used for: **SMV KONECRANES**

**type A**  
3-bolt fixing

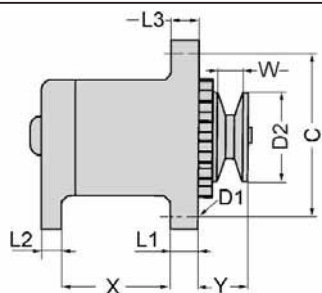

**type B**  
2-bolt fixing

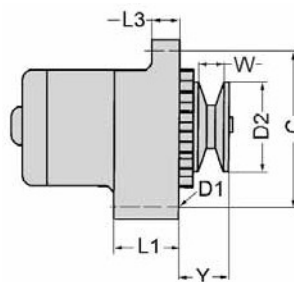

**type S**  
special types

voltage (volt)	type	dimension (mm)	dimension (mm)	dimension (mm)	dimension (mm)	dimension (mm)	dimension (mm)	dimension (mm)	dimension (mm)	regulator	reference new
U	TY	X	L1	L2	L3	Y	D2	W	C	REG	
24	A	106	14	14	14	45	68	30	198	V	<a href="#">135TA1936</a>
	B		50,8			25			188	V	<a href="#">108TA4273</a>
28	B		56			56,1			155	V	<a href="#">135TA1840</a>



REF [135TA1936](#)



REF [108TA4273](#)



REF [135TA1840](#)



# ALTERNATORS

For all our latest catalogue updates and company info: [www.tvh.com](http://www.tvh.com)



ALTERNATORS

used for: **STILL**

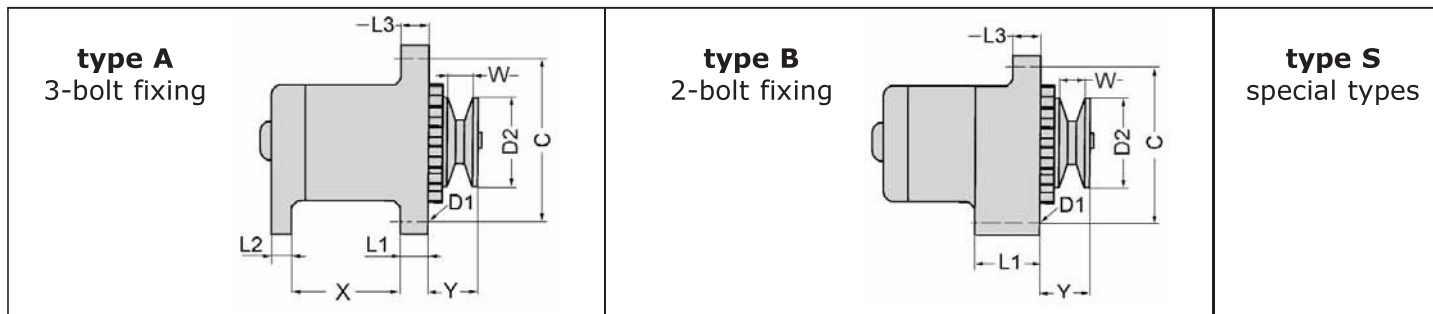

voltage (volt)	type	dimension (mm)	dimension (mm)	dimension (mm)	dimension (mm)	dimension (mm)	dimension (mm)	dimension (mm)	dimension (mm)	regulator	reference new
U	TY	X	L1	L2	L3	Y	D2	W	C	REG	
12	A	64,5	16,5	16	15		71		166	V	<a href="#">124TA6613</a>
	A	66	27	4	11	29	67	12	162	V	<a href="#">124TA6727</a>
	A	71,3	27,1	20	11	37,5	56	17	171	V	<a href="#">124TA6678</a>
	A	81,5	12,5	12,5	12,5	38	74	12	150	V	<a href="#">106TA5140</a>
	A	82	11,5	11,4	11,5				148	V	<a href="#">135TA1884</a>
	B		27		11		76,5		161	V	<a href="#">135TA1745</a>
	B		27		11	33,5	63	19	160	V	<a href="#">135TA1903</a>
	B		51		16,5				167	V	<a href="#">124TA6569</a>
	B		55,5		13	55	67	11	175	V	<a href="#">116TA7374</a>



# ALTERNATORS

For all our latest catalogue updates and company info: [www.tvh.com](http://www.tvh.com)

ALTERNATORS

used for: **STILL**

**type A**  
3-bolt fixing

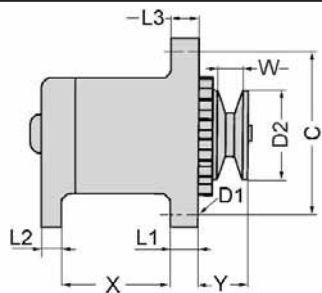

**type B**  
2-bolt fixing

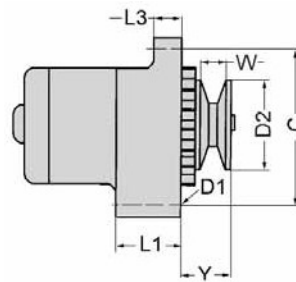

**type S**  
special types

voltage (volt)	type	dimension (mm)	dimension (mm)	dimension (mm)	dimension (mm)	dimension (mm)	dimension (mm)	dimension (mm)	dimension (mm)	regulator	reference new
U	TY	X	L1	L2	L3	Y	D2	W	C	REG	
12	B		56		10	28	72,5	11	144	V	<a href="#">105TA5752</a>
	B		56		14	53,5	66,5	12,5	173	V	<a href="#">105TA5749</a>
	B		56		56				156	V	<a href="#">136TA3800</a>
	B		80		15				150	V	<a href="#">136TA3793</a>
24	B		56		10,3	68	61	23	150	V	<a href="#">136TA3851</a>
	B		56		12	27	72,5	11	144	V	<a href="#">136TA3791</a>
	B		56		56				155	V	<a href="#">105TA5748</a>
	B		56		56				156	V	<a href="#">136TA3806</a>
	B		56		56				156	V	<a href="#">136TA3795</a>



REF [105TA5752](#)



REF [105TA5749](#)



REF [136TA3800](#)



REF [136TA3793](#)



REF [136TA3851](#)



REF [136TA3791](#)



REF [105TA5748](#)



REF [136TA3806](#)



REF [136TA3795](#)



# ALTERNATORS



For all our latest catalogue updates and company info: [www.tvh.com](http://www.tvh.com)

used for: **STILL**

ALTERNATORS

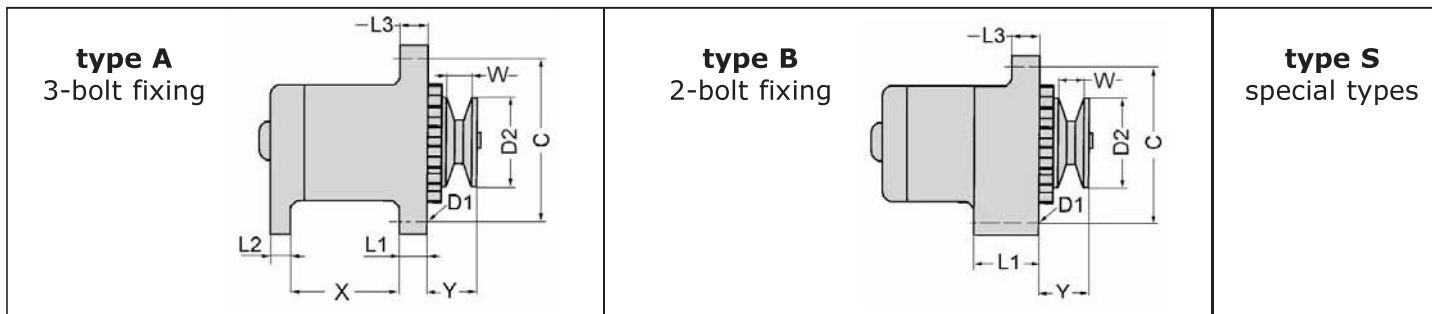

voltage (volt)	type	dimension (mm)	dimension (mm)	dimension (mm)	dimension (mm)	dimension (mm)	dimension (mm)	dimension (mm)	dimension (mm)	dimension (mm)	regulator	reference new
U	TY	X	L1	L2	L3	Y	D2	W	C	REG		
24	B		56		56				156	V	<a href="#">136TA3786</a>	
	B		56		56	58	64	23	155	V	<a href="#">136TA3794</a>	
28	B		56		10	62	73	16	150	V	<a href="#">136TA3823</a>	
	B		56		56				156	V	<a href="#">136TA3808</a>	



# ALTERNATORS

For all our latest catalogue updates and company info: [www.tvh.com](http://www.tvh.com)

ALTERNATORS

used for: **SVE TRUCK**

**type A**  
3-bolt fixing

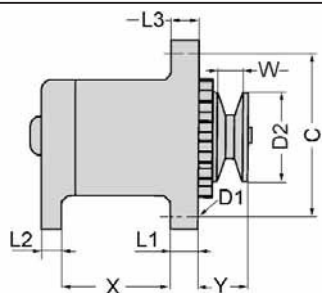

**type B**  
2-bolt fixing

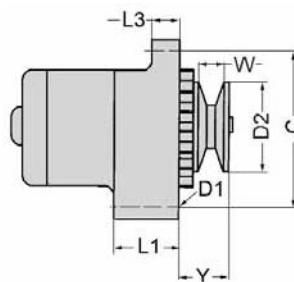

**type S**  
special types

voltage (volt)	type	dimension (mm)	dimension (mm)	dimension (mm)	dimension (mm)	dimension (mm)	dimension (mm)	dimension (mm)	dimension (mm)	regulator	reference new
U	TY	X	L1	L2	L3	Y	D2	W	C	REG	
24	A	101	14	13,5	14				198	V	<a href="#">136TA3836</a>
	A	102	14	14	14				197	V	<a href="#">136TA3833</a>
	A	103,8	14,5	14	14,5				198	V	<a href="#">135TA1842</a>
	A	180	16	20	16				208	V	<a href="#">135TA1841</a>
	B		50,8		16,4	32	72,6	10	170	V	<a href="#">135TA1788</a>
	B		50,8		25				188	V	<a href="#">135TA1734</a>
	B		51		14				171	V	<a href="#">135TA1759</a>
	B		51		16				164	V	<a href="#">105TA5753</a>
	B		51		25,7				195	V	<a href="#">135TA1736</a>



REF [136TA3836](#)



REF [136TA3833](#)



REF [135TA1842](#)



REF [135TA1841](#)



REF [135TA1788](#)



REF [135TA1734](#)



REF [135TA1759](#)



REF [105TA5753](#)



REF [135TA1736](#)







# ALTERNATORS

For all our latest catalogue updates and company info: [www.tvh.com](http://www.tvh.com)



ALTERNATORS

used for: **TCM**

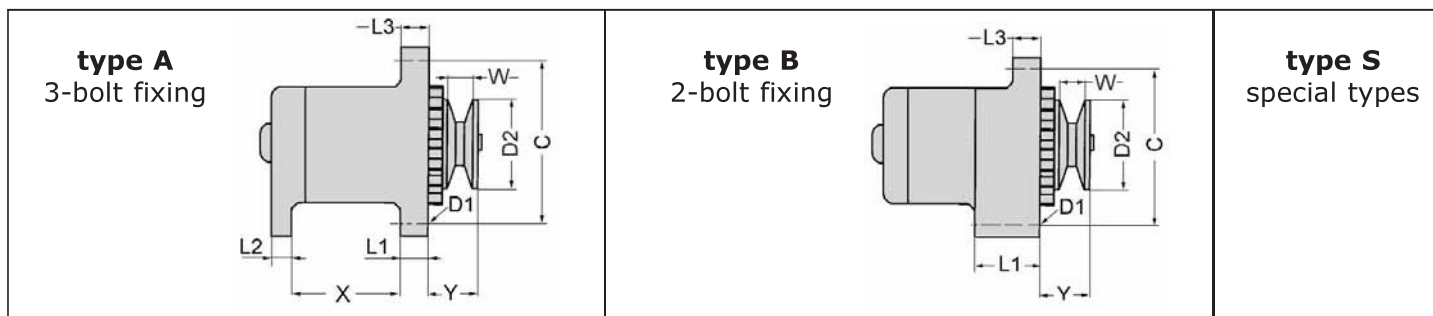

voltage (volt)	type	dimension (mm)	dimension (mm)	dimension (mm)	dimension (mm)	dimension (mm)	dimension (mm)	dimension (mm)	dimension (mm)	regulator	reference new
U	TY	X	L1	L2	L3	Y	D2	W	C	REG	
12	A	67,3	12	11,6	12	39	72	14	156		<a href="#">135TA1801</a>
	A	68	12	11,6	12	45	69	10	143	V	<a href="#">128TA3700</a>
	A	78	12,8	13	13	39	68	12	175	V	<a href="#">105TA5787</a>
	A	78,5	13	16,5	13	39	84	13	175	V	<a href="#">135TA1912</a>
	A	79,8	13	13	13	50	70	13	155	V	<a href="#">116TA7281</a>
	A	80	13	13	13		74	13	155		<a href="#">136TA3857</a>
	A	80	13	13	13	37	69	10	155	V	<a href="#">103TA3781</a>
	A	80	13	13	13	38,5	69	10	156	V	<a href="#">124TA6710</a>
	A	80	13	13	13	39	72	12	155	V	<a href="#">105TA5786</a>



# ALTERNATORS

For all our latest catalogue updates and company info: [www.tvh.com](http://www.tvh.com)

ALTERNATORS

used for: **TCM**

**type A**  
3-bolt fixing

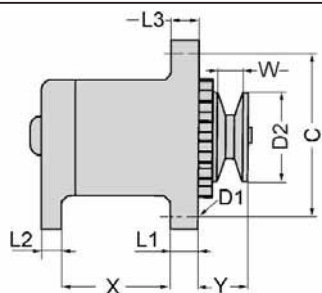

**type B**  
2-bolt fixing

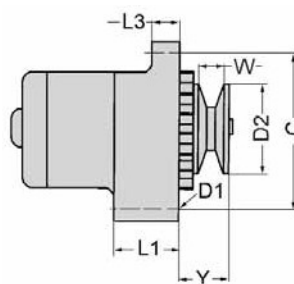

**type S**  
special types

voltage (volt)	type	dimension (mm)	dimension (mm)	dimension (mm)	dimension (mm)	dimension (mm)	dimension (mm)	dimension (mm)	dimension (mm)	dimension (mm)	regulator	reference new
U	TY	X	L1	L2	L3	Y	D2	W	C	REG		
12	A	80	13	13	13	42	70	13	155	V		<a href="#">128TA3815</a>
	A	80	13	13	13	44	82	17	155	V		<a href="#">128TA3644</a>
	A	80	13	13	13	45			155	V		<a href="#">105TA5779</a>
	A	80	13	13	13,5	36,5	70	13	155			<a href="#">135TA1714</a>
	A	80	13	14	13	38,5	68,5	15	175	V		<a href="#">105TA5783</a>
	A	80	13,5	13	13	35,5	84	12	172	V		<a href="#">105TA5776</a>
	A	80,1	13,1	13,1	13,1	40	73,4	12,5	155			<a href="#">105TA5759</a>
	A	80,4	13	13	13	54	70	28,5	175	V		<a href="#">135TA1796</a>
	A	80,5	13	13	13	37	73,5	13	155			<a href="#">108TA8287</a>



REF [128TA3815](#)

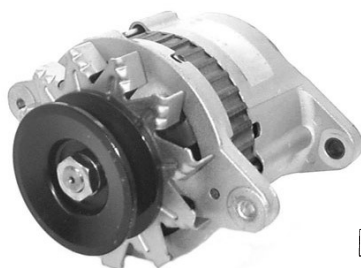

REF [128TA3644](#)



REF [105TA5779](#)



REF [135TA1714](#)



REF [105TA5783](#)



REF [105TA5776](#)



REF [105TA5759](#)



REF [135TA1796](#)



REF [108TA8287](#)



# ALTERNATORS

For all our latest catalogue updates and company info: [www.tvh.com](http://www.tvh.com)



ALTERNATORS

used for: **TCM**

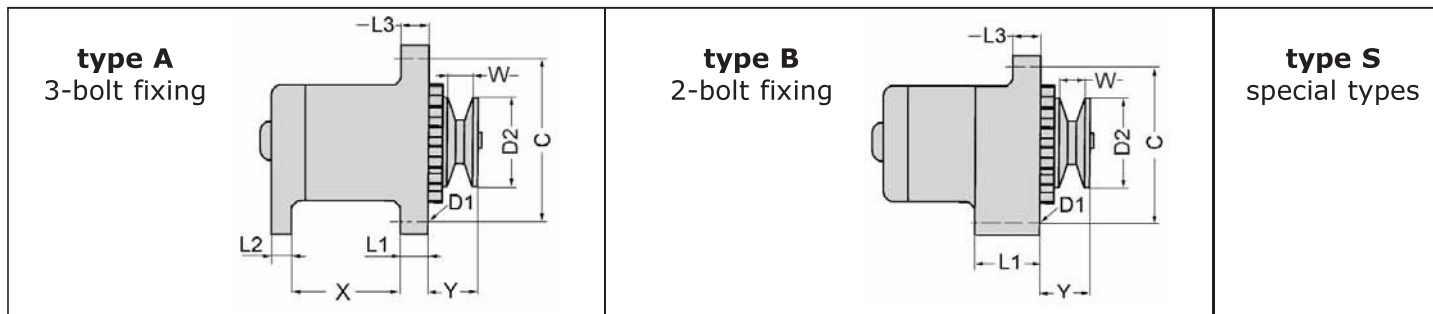

voltage (volt)	type	dimension (mm)	dimension (mm)	dimension (mm)	dimension (mm)	dimension (mm)	dimension (mm)	dimension (mm)	dimension (mm)	regulator	reference new
U	TY	X	L1	L2	L3	Y	D2	W	C	REG	
12	A	80,5	13	13	13	40	72	14	156	V	<a href="#">128TA3902</a>
	A	80,5	13	13	13	40	73,5	14	174	V	<a href="#">136TA3788</a>
	A	80,5	13	13	13	40,5	77	13	175	V	<a href="#">124TA6738</a>
	A	80,5	13	13	13,5	57	84,5	33	175,5	V	<a href="#">124TA6649</a>
	A	80,5	13,5	13	13,5	53,5	69	28	155		<a href="#">105TA5778</a>
	A	80,5	14,5	13,5	14,5	37	72	12	157	V	<a href="#">105TA5780</a>
	A	80,7	13	13	13	39	71,7	10	174,5		<a href="#">135TA1943</a>
	A	81	12	12	12	45	82	17	170	V	<a href="#">107TA9452</a>
	A	81	12	12,5	12,5	39	71,5	14	180	V	<a href="#">105TA5774</a>



# ALTERNATORS

For all our latest catalogue updates and company info: [www.tvh.com](http://www.tvh.com)

ALTERNATORS

used for: **TCM**

**type A**  
3-bolt fixing

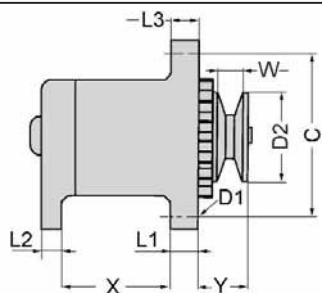

**type B**  
2-bolt fixing

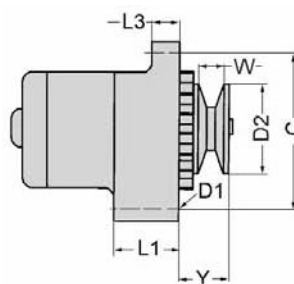

**type S**  
special types

voltage (volt)	type	dimension (mm)	dimension (mm)	dimension (mm)	dimension (mm)	dimension (mm)	dimension (mm)	dimension (mm)	dimension (mm)	dimension (mm)	regulator	reference new
U	TY	X	L1	L2	L3	Y	D2	W	C	REG		
12	A	81	13	13	13	57	85	30	175	V		<a href="#">136TA3849</a>
	A	82	12,5	12,5	13	40	69	10	155	V		<a href="#">116TA7261</a>
	A	82,5	13	13	13	42	72	12,5	155	V		<a href="#">107TA9450</a>
	A	82,7	13	13	13	42,5	82	17	158	V		<a href="#">109TA5983</a>
	A	98	10,5	10	10,8	42			157	V		<a href="#">124TA6682</a>
	A	98	13	10	12	38			150			<a href="#">105TA5761</a>
	A	98	13	13	13	48	74	25	174	V		<a href="#">105TA5781</a>
	A	98,5	12	13	12	41	77		155	V		<a href="#">124TA6681</a>
	A	98,5	13	10	13,5	36,5	69,5	10,5	155	V		<a href="#">105TA5757</a>



REF [136TA3849](#)



REF [116TA7261](#)



REF [107TA9450](#)



REF [109TA5983](#)



REF [124TA6682](#)



REF [105TA5761](#)



REF [105TA5781](#)



REF [124TA6681](#)



REF [105TA5757](#)



# ALTERNATORS

For all our latest catalogue updates and company info: [www.tvh.com](http://www.tvh.com)



ALTERNATORS

used for: **TCM**

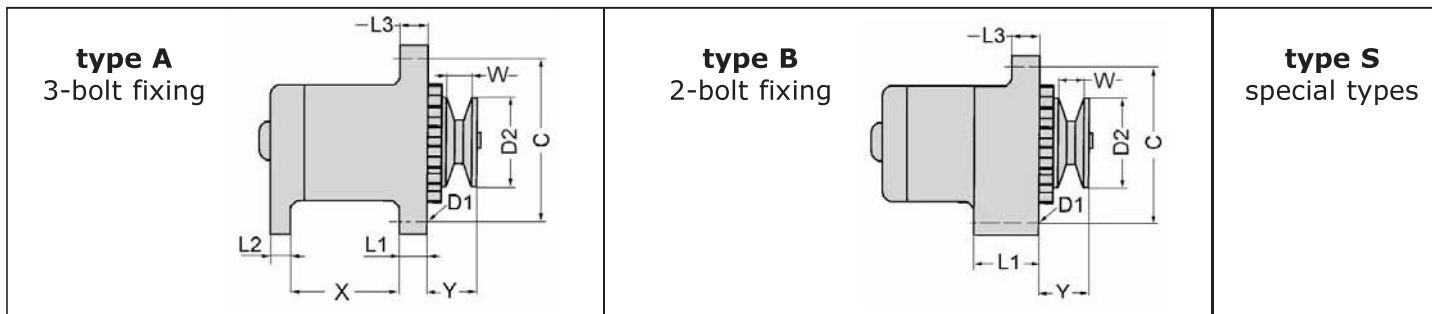

voltage (volt)	type	dimension (mm)	dimension (mm)	dimension (mm)	dimension (mm)	dimension (mm)	dimension (mm)	dimension (mm)	dimension (mm)	regulator	reference new
U	TY	X	L1	L2	L3	Y	D2	W	C	REG	
12	A	99,5	14	15	12,2	52			170		<a href="#">107TA9502</a>
	B		15		13	39	74,5	14	155,5	V	<a href="#">135TA1873</a>
	B		21		16	31	68	12	155	V	<a href="#">128TA3940</a>
	B		21		16	35	74	10	138	V	<a href="#">105TA5775</a>
	B		21,3		15,5	35	74,5	14	138	V	<a href="#">124TA6740</a>
	B		21,5		16	32	76	14	140	V	<a href="#">124TA6601</a>
	B		23,5		16	32	69	13	138	V	<a href="#">135TA2472</a>
	B		23,5		16,5	31,5	74	13,5	137	V	<a href="#">105TA5788</a>
	B		24		16	30,5	70	12	138	V	<a href="#">136TA8347</a>



# ALTERNATORS

For all our latest catalogue updates and company info: [www.tvh.com](http://www.tvh.com)

ALTERNATORS

used for: **TCM**

**type A**  
3-bolt fixing

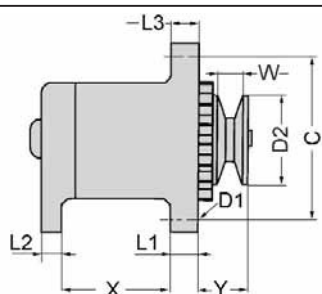

**type B**  
2-bolt fixing

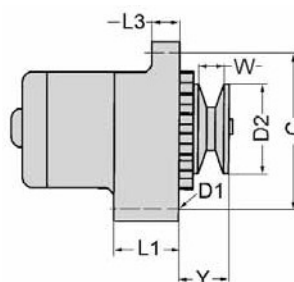

**type S**  
special types

voltage (volt)	type	dimension (mm)	dimension (mm)	dimension (mm)	dimension (mm)	dimension (mm)	dimension (mm)	dimension (mm)	dimension (mm)	regulator	reference new
U	TY	X	L1	L2	L3	Y	D2	W	C	REG	
12	B		24,2		16	30	74	13	140	V	<a href="#">124TA6692</a>
	B		24,4		15,8	57	63	10	138	V	<a href="#">124TA6650</a>
	B		29		17	45	74	12	155	V	<a href="#">128TA3913</a>
	B		51		12	41	69	17,5	155		<a href="#">105TA5767</a>
	B		52		17	43,5	68	21,5	165	V	<a href="#">135TA1752</a>
	B		57,5		16	44	63	14	165	V	<a href="#">135TA1878</a>
24	A	70	13	24	16	76	82	35	225	V	<a href="#">135TA1909</a>
	A	70	16	15,5	16	77	82	38	195	V	<a href="#">105TA5756</a>
	A	70	16	16	16	76,5	82	35,5	196	V	<a href="#">107TA9465</a>





# ALTERNATORS

For all our latest catalogue updates and company info: [www.tvh.com](http://www.tvh.com)



ALTERNATORS

used for: **TCM**

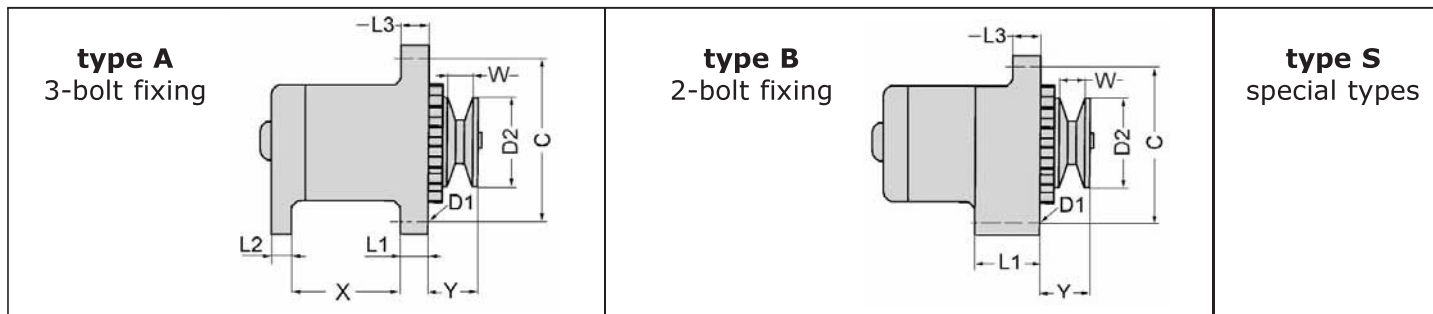

voltage (volt)	type	dimension (mm)	dimension (mm)	dimension (mm)	dimension (mm)	dimension (mm)	dimension (mm)	dimension (mm)	dimension (mm)	regulator	reference new
U	TY	X	L1	L2	L3	Y	D2	W	C	REG	
24	A	70	16	16,5	16	96	82	57,5	225	V	<a href="#">107TA9487</a>
	A	70	16,3	16,3	15,7	78	92	35	213	V	<a href="#">136TA3853</a>
	A	70,5	16	16	16	75	80	35,5	196		<a href="#">105TA5890</a>
	A	70,5	16	16	16	75,5	82	38	224	V	<a href="#">135TA1758</a>
	A	70,5	16	16	16	76	82	35,5	190	V	<a href="#">105TA5765</a>
	A	70,5	16	16	16	76	82,2	36	190	V	<a href="#">105TA5755</a>
	A	70,5	16	16	16	76	92	36	212	V	<a href="#">107TA9485</a>
	A	72	12	12	16	83	95,5	35	170	V	<a href="#">116TA7284</a>
	A	78,5	13	16,5	13	55	74	32	175	V	<a href="#">136TA3872</a>



# ALTERNATORS

For all our latest catalogue updates and company info: [www.tvh.com](http://www.tvh.com)

ALTERNATORS

used for: **TCM**

**type A**  
3-bolt fixing

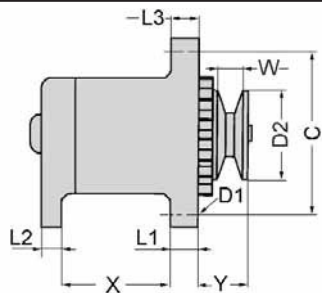

**type B**  
2-bolt fixing

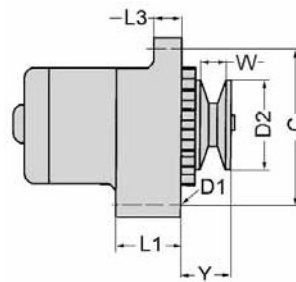

**type S**  
special types

voltage (volt)	type	dimension (mm)	dimension (mm)	dimension (mm)	dimension (mm)	dimension (mm)	dimension (mm)	dimension (mm)	dimension (mm)	dimension (mm)	regulator	reference new
U	TY	X	L1	L2	L3	Y	D2	W	C	REG		
24	A	80	13	13	13	54	80,5	29	155			<a href="#">128TA3471</a>
	A	80	13	18	14	55	82	16	190	V		<a href="#">135TA1906</a>
	A	80	13,5	13	13	42,5	82	16	156	V		<a href="#">107TA9501</a>
	A	80,5	14,8	13	14,6	37,5	72	12	155	V		<a href="#">105TA5766</a>
	A	82	13	13	13	46,5	77	16	155	V		<a href="#">116TA7277</a>
	A	86	14	14	14,2	67,5	84	39	222	V		<a href="#">128TA3687</a>
	B		50,8		25				188	V		<a href="#">128TA3531</a>



# ALTERNATORS



For all our latest catalogue updates and company info: [www.tvh.com](http://www.tvh.com)

used for: **TENNANT**

ALTERNATORS

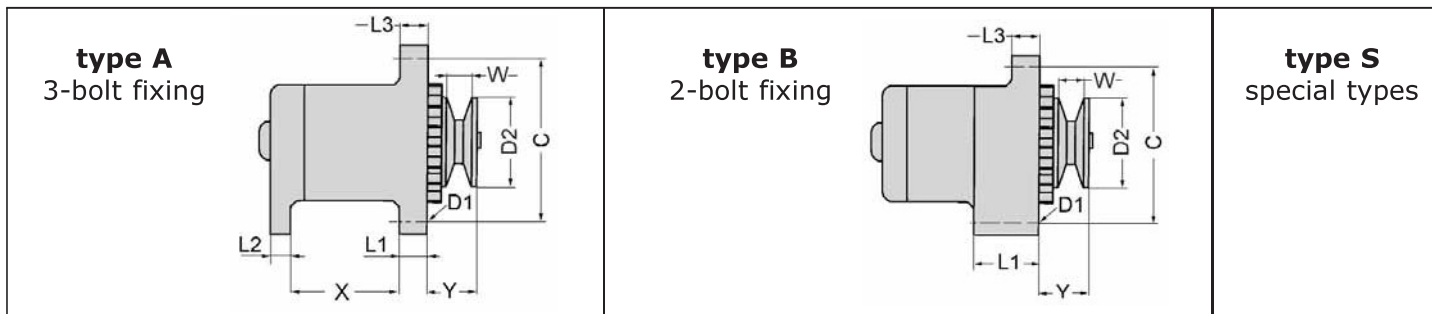

voltage (volt)	type	dimension (mm)	dimension (mm)	dimension (mm)	dimension (mm)	dimension (mm)	dimension (mm)	dimension (mm)	dimension (mm)	regulator	reference new
U	TY	X	L1	L2	L3	Y	D2	W	C	REG	
12	B		24,4		15,8	57	63	10	138	V	<a href="#">135TA1781</a>
	B		27		11,5				165	V	<a href="#">103TA3721</a>
	B		50,8		16,5	34	73	12	166	V	<a href="#">135TA1799</a>



# ALTERNATORS

For all our latest catalogue updates and company info: [www.tvh.com](http://www.tvh.com)

ALTERNATORS

used for: **TOYOTA**

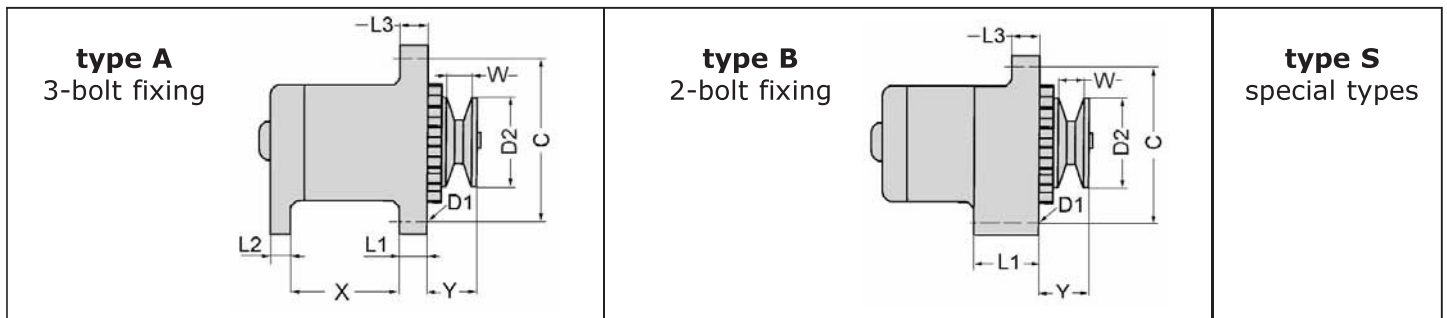

voltage (volt)	type	dimension (mm)	dimension (mm)	dimension (mm)	dimension (mm)	dimension (mm)	dimension (mm)	dimension (mm)	dimension (mm)	dimension (mm)	regulator	reference new
U	TY	X	L1	L2	L3	Y	D2	W	C	REG		
12	A	65	13	12	13,5	41,5			155	V	<a href="#">103TA3719</a>	
	A	67	12,5	12,5	12	41,5	74	14	168		<a href="#">128TA3610</a>	
	A	67	15	12	15	45,5	77,5	17,5	168	V	<a href="#">105TA5804</a>	
	A	67	15	12,3	15	39	72	12	168		<a href="#">103TA3677</a>	
	A	67	15	13	15	38,5	72	13,5	170	V	<a href="#">124TA6691</a>	
	A	67	20	12	16	34	71,5	16	155	V	<a href="#">124TA6634</a>	
	A	67	20	12	16	40	76	16	156	V	<a href="#">128TA3943</a>	
	A	67	20	12	16	41	75	17	156	V	<a href="#">136TA3783</a>	
	A	67	20	12	16	42	75	17	155	V	<a href="#">124TA6598</a>	

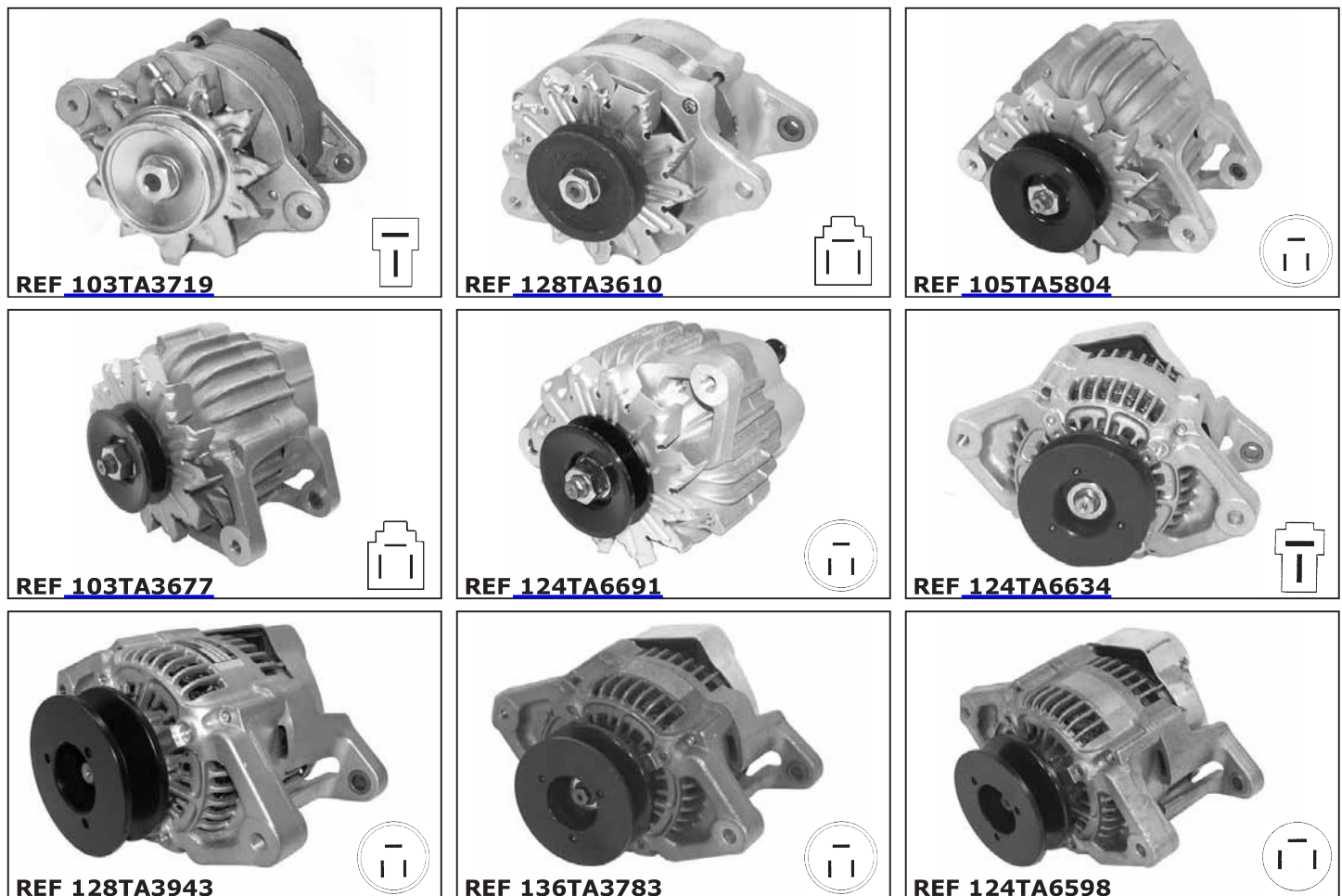

# ALTERNATORS

For all our latest catalogue updates and company info: [www.tvh.com](http://www.tvh.com)



ALTERNATORS

used for: **TOYOTA**

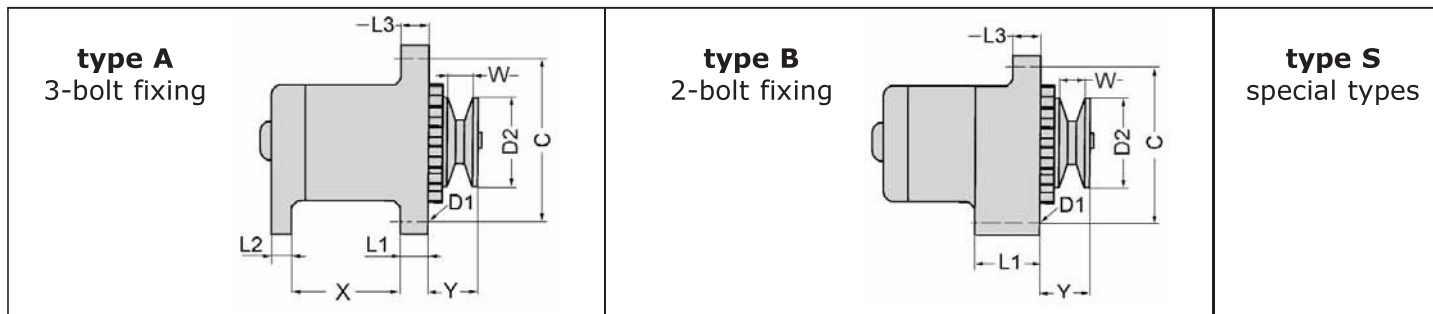

voltage (volt)	type	dimension (mm)	dimension (mm)	dimension (mm)	dimension (mm)	dimension (mm)	dimension (mm)	dimension (mm)	dimension (mm)	regulator	reference new
U	TY	X	L1	L2	L3	Y	D2	W	C	REG	
12	A	67,3	20	12	16,3	32,5	69	12	155,5	V	<a href="#">128TA3668</a>
	A	67,5	12	12,5	12	48	82,5	16,5	168	V	<a href="#">124TA6684</a>
	A	67,5	20	12,5	16	40	76	16	155	V	<a href="#">128TA3515</a>
	A	75,2	12	12	12	48	82	16	170	V	<a href="#">124TA6744</a>
	A	75,2	12	12	12,4	39	67,5	11,4	171		<a href="#">128TA3583</a>
	A	75,5	12	12	12	42	72	14	180		<a href="#">105TA5800</a>
	A	76	12,5	12	12	41,5	69	14	166	V	<a href="#">105TA5794</a>
	A	77	12	11,5	12	47	82	16,5	170		<a href="#">103TA3795</a>
	A	81	12	12	12	40	69	12	155	V	<a href="#">116TA7349</a>



# ALTERNATORS

For all our latest catalogue updates and company info: [www.tvh.com](http://www.tvh.com)

ALTERNATORS

used for: **TOYOTA**

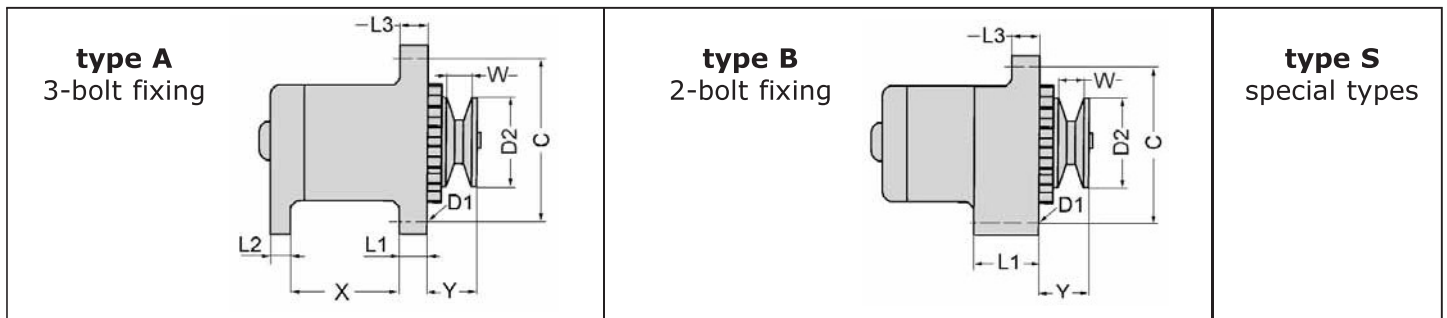

voltage (volt)	type	dimension (mm)	dimension (mm)	dimension (mm)	dimension (mm)	dimension (mm)	dimension (mm)	dimension (mm)	dimension (mm)	regulator	reference new
U	TY	X	L1	L2	L3	Y	D2	W	C	REG	
12	A	82,8	11,3	12,3	11,3	32	64	12	150	V	<a href="#">128TA3730</a>
	A	105	14,2	14,5	14	47	82	16,5	170	V	<a href="#">124TA6730</a>
	A	105,5	14	15	14	47,5	82	16,5	175	V	<a href="#">103TA3778</a>
	B		21		16	35	74,5	13	155	V	<a href="#">103TA3819</a>
	B		21		16	35,5	74	12	155	V	<a href="#">107TA9550</a>
	B		21,2		16	31	67		155	V	<a href="#">116TA7350</a>
	B		21,5		16	32	76	14	140	V	<a href="#">128TA3522</a>
	B		23,4		16,6	32	74	13,5	138	V	<a href="#">135TA1945</a>
	B		23,5		16,5	31,5	74	13,5	137	V	<a href="#">124TA6697</a>



# ALTERNATORS

For all our latest catalogue updates and company info: [www.tvh.com](http://www.tvh.com)



ALTERNATORS

used for: **TOYOTA**

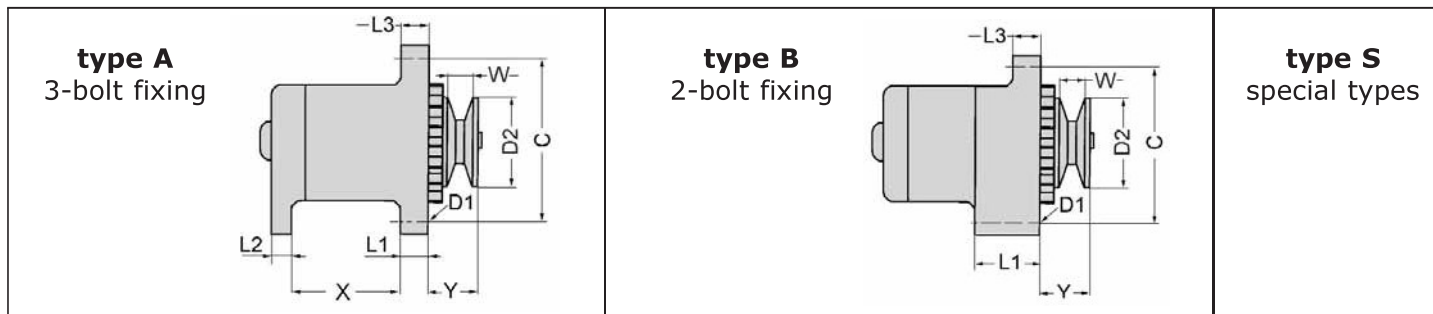

voltage (volt)	type	dimension (mm)	dimension (mm)	dimension (mm)	dimension (mm)	dimension (mm)	dimension (mm)	dimension (mm)	dimension (mm)	regulator	reference new
U	TY	X	L1	L2	L3	Y	D2	W	C	REG	
12	B		24		16,5	30,5	74	14	138	V	<a href="#">128TA3511</a>
	B		24		16,5	31	74	12	140	V	<a href="#">117TA8564</a>
	B		29		17	43	74	12	157	V	<a href="#">135TA1926</a>
	B		51		16,3				173	V	<a href="#">135TA1854</a>
	B		57,5		16	48	64	20	161	V	<a href="#">105TA5796</a>
	B		57,5		22	57	71,5	25	160	V	<a href="#">128TA3753</a>
	B		58		15,6	47	56,5	16,3	150	V	<a href="#">105TA5801</a>
	B		58		15,8	58,5	72	25,5	150	V	<a href="#">116TA7375</a>
	B		58		16	36,5	57,5	23	164	V	<a href="#">135TA1917</a>



# ALTERNATORS

For all our latest catalogue updates and company info: [www.tvh.com](http://www.tvh.com)

ALTERNATORS

used for: **TOYOTA**

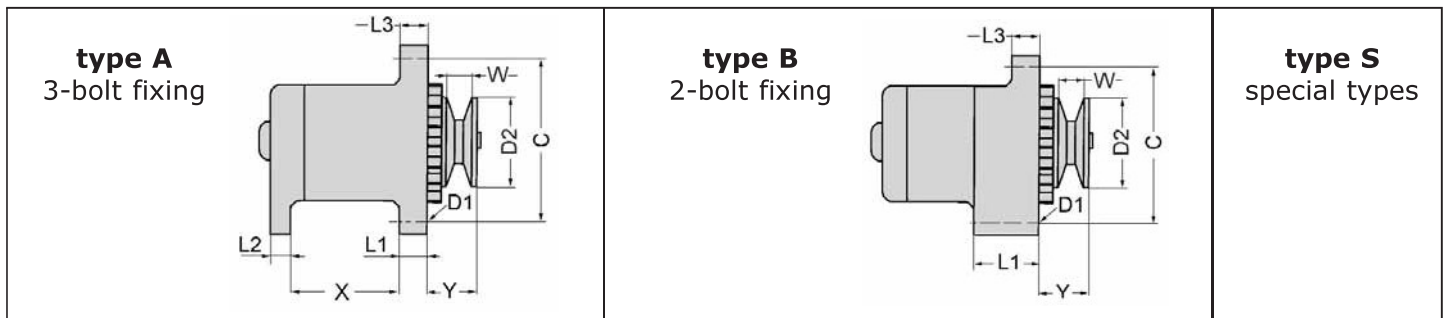

voltage (volt)	type	dimension (mm)	dimension (mm)	dimension (mm)	dimension (mm)	dimension (mm)	dimension (mm)	dimension (mm)	dimension (mm)	regulator	reference new
U	TY	X	L1	L2	L3	Y	D2	W	C	REG	
12	B		58		16	45	63	10	165	V	<a href="#">135TA1952</a>
	B		58		16	46	82	16	165	V	<a href="#">135TA1868</a>
	B		58		16	47,5	76	16,5	163	V	<a href="#">105TA5806</a>
	B		58		16	51	76	15	164,5	V	<a href="#">124TA6652</a>
	B		58		16	53	82	16,5	165	V	<a href="#">107TA9507</a>
	B		58		16	60	66,6	23	163	V	<a href="#">136TA3862</a>
	B		58	16	0	48	74,2	12	163	V	<a href="#">136TA3855</a>
	B		58,4		22	43	82	14	157	V	<a href="#">103TA3754</a>
	B		72		20				157	V	<a href="#">135TA1831</a>

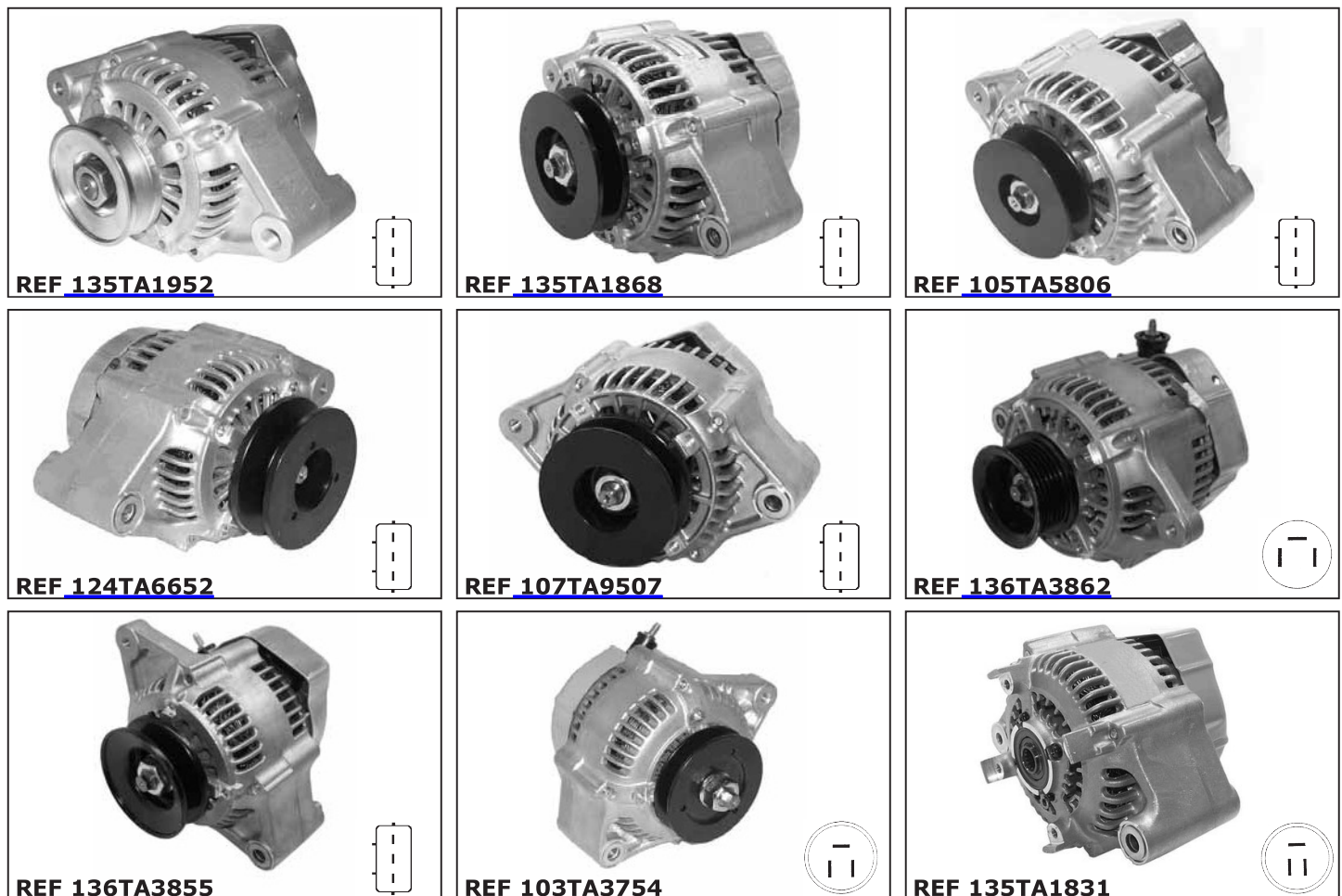



# ALTERNATORS

For all our latest catalogue updates and company info: [www.tvh.com](http://www.tvh.com)



ALTERNATORS

## used for: TOYOTA

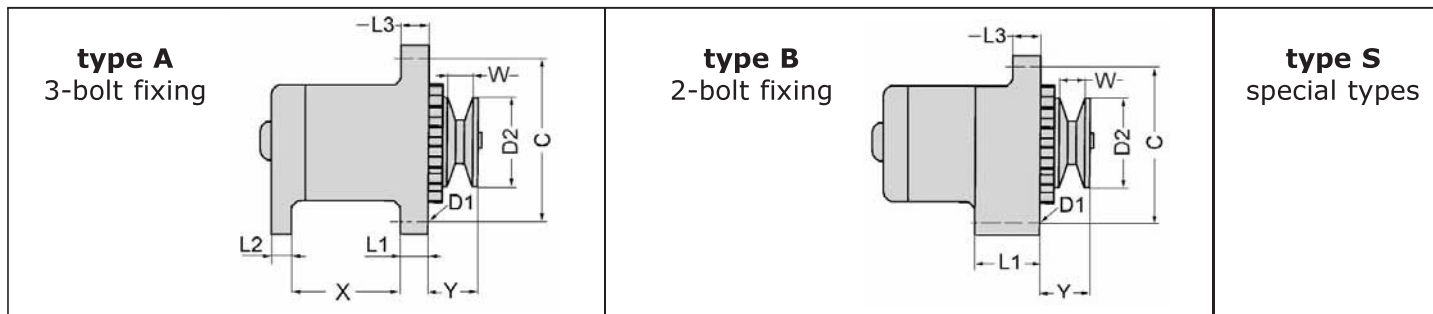

voltage (volt)	type	dimension (mm)	dimension (mm)	dimension (mm)	dimension (mm)	dimension (mm)	dimension (mm)	dimension (mm)	dimension (mm)	regulator	reference new
U	TY	X	L1	L2	L3	Y	D2	W	C	REG	
12	B		72		20	91	76	16	157	V	<a href="#">124TA6741</a>
	B		76,5		13,5	45	72	14	175	V	<a href="#">135TA1811</a>
24	A	67	20	12	16	40	76	15,5	155	V	<a href="#">105TA5799</a>
	A	67	20	12	16	40	76	16	155	V	<a href="#">128TA3548</a>
	A	67	20,5	12,5	16	40	76	16	155	V	<a href="#">103TA3709</a>
	A	75,5	12,2	12,3	12	48	82	16,5	168		<a href="#">107TA9505</a>
	A	75,5	15	12,5	15	45	77,5	17	170	V	<a href="#">107TA9553</a>
	A	75,8	12	11,4	12	49,3	83	17,3	168		<a href="#">128TA3699</a>
	A	76	12	12	12,5	47,5	83	17,3	167		<a href="#">105TA5808</a>



# ALTERNATORS

For all our latest catalogue updates and company info: [www.tvh.com](http://www.tvh.com)

ALTERNATORS

used for: **TOYOTA**

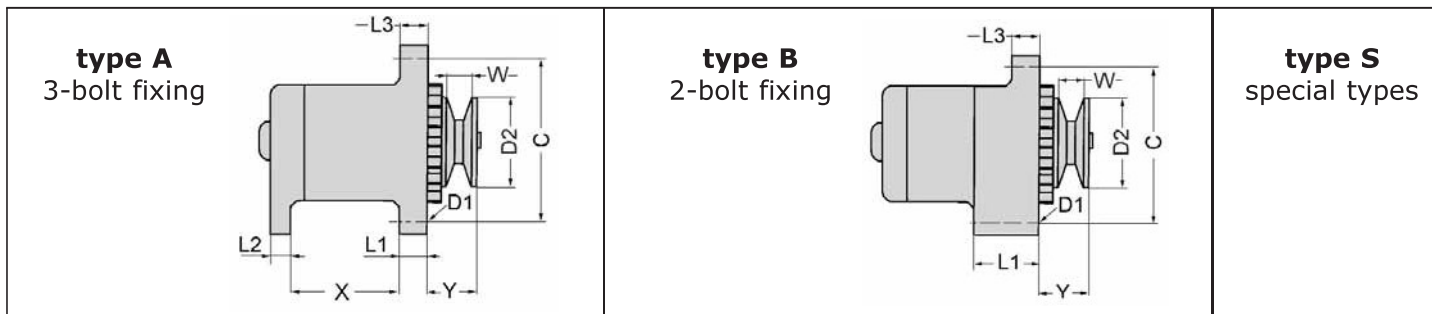

voltage (volt)	type	dimension (mm)	dimension (mm)	dimension (mm)	dimension (mm)	dimension (mm)	dimension (mm)	dimension (mm)	dimension (mm)	dimension (mm)	regulator	reference new
U	TY	X	L1	L2	L3	Y	D2	W	C	REG		
24	A	86	14	14	14	68	82	36	220	V		<a href="#">103TA3791</a>
	A	105,4	14	15,2	14	79	102	37	174	V		<a href="#">105TA5793</a>
	A	105,5	14	15	14	48	82	16,5	177			<a href="#">103TA3790</a>
	A	105,5	14	15	14	64,5	91	16,5	174			<a href="#">103TA3752</a>
	A	105,5	14	15	14	78			175	V		<a href="#">128TA3888</a>
	A	105,5	14	15,5	14	79	102	36,5	177			<a href="#">103TA3792</a>
	A	105,5	14	18	14,2	78	102	45	176			<a href="#">135TA1910</a>
	A	106	15	14	14,3	63			175			<a href="#">105TA5792</a>
	A	111	14	13	14	64,5	92	18	171			<a href="#">107TA9458</a>



# ALTERNATORS



For all our latest catalogue updates and company info: [www.tvh.com](http://www.tvh.com)

ALTERNATORS

## used for: **TOYOTA**

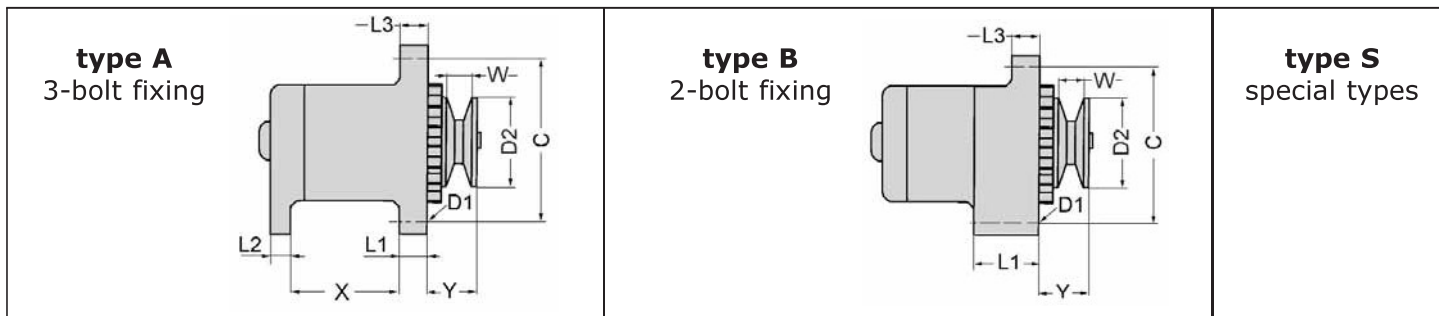

voltage (volt)	type	dimension (mm)	dimension (mm)	dimension (mm)	dimension (mm)	dimension (mm)	dimension (mm)	dimension (mm)	dimension (mm)	regulator	reference new
U	TY	X	L1	L2	L3	Y	D2	W	C	REG	
24	A	111	14	13	14	78	102	45	172		<a href="#">135TA1953</a>
	A	111	14	13,5	14	65	92	17,5	173		<a href="#">105TA5789</a>

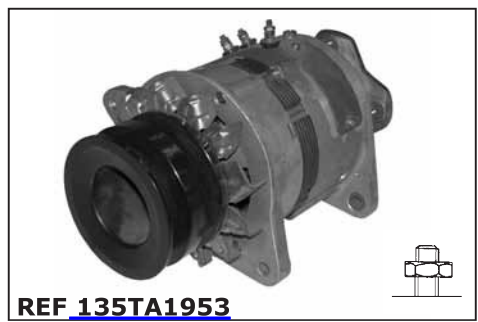



# ALTERNATORS

For all our latest catalogue updates and company info: [www.tvh.com](http://www.tvh.com)



ALTERNATORS

used for: **YALE**

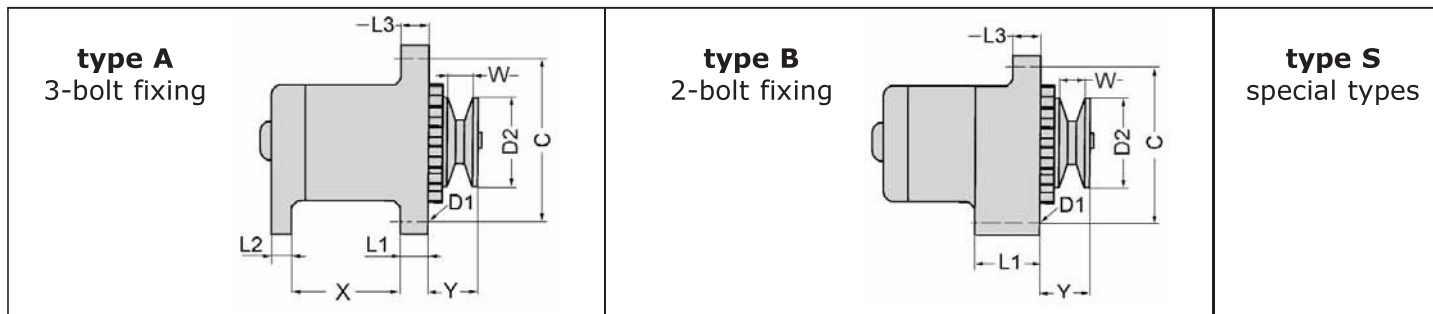

voltage (volt)	type	dimension (mm)	dimension (mm)	dimension (mm)	dimension (mm)	dimension (mm)	dimension (mm)	dimension (mm)	dimension (mm)	regulator	reference new
U	TY	X	L1	L2	L3	Y	D2	W	C	REG	
12	A	41	16,5	13	13	33,5	68	14	145	V	<a href="#">128TA3573</a>
	A	64,5	16,5	12	16,5	47,5	67	23	155	V	<a href="#">128TA3857</a>
	A	65,5	13	14	13	40	74	12	175		<a href="#">135TA1744</a>
	A	67	20	12	16	41	75	17	156	V	<a href="#">135TA1739</a>
	A	67	20	12	16	42	75	17	155	V	<a href="#">135TA1726</a>
	A	78	12,8	13	13	39	68	12	175	V	<a href="#">124TA6584</a>
	A	80	13	13	13	38	68	14	175	V	<a href="#">105TA5817</a>
	A	80	13	13	13	39,3	78,6	14	157	V	<a href="#">135TA1775</a>
	A	80,1	13,1	13,1	13,1	40	73,4	12,5	155		<a href="#">135TA1698</a>



# ALTERNATORS

For all our latest catalogue updates and company info: [www.tvh.com](http://www.tvh.com)

ALTERNATORS

used for: **YALE**

**type A**  
3-bolt fixing

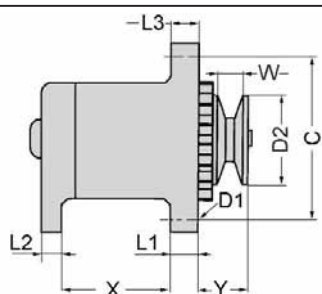

**type B**  
2-bolt fixing

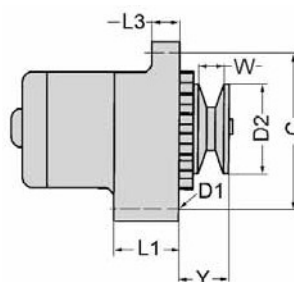

**type S**  
special types

voltage (volt)	type	dimension (mm)	dimension (mm)	dimension (mm)	dimension (mm)	dimension (mm)	dimension (mm)	dimension (mm)	dimension (mm)	regulator	reference new
U	TY	X	L1	L2	L3	Y	D2	W	C	REG	
12	A	80,5	13	13,5	13	40	67	13	155	V	<a href="#">124TA6677</a>
	A	80,5	13,5	13,5	13	40	73	13,5	155	V	<a href="#">124TA6585</a>
	A	80,5	14	20	14				149		<a href="#">135TA1914</a>
	A	80,5	14,5	13,5	14,5	37	72	12	157	V	<a href="#">128TA3491</a>
	A	81	13	13	13	43,8	93,5	19,5	155	V	<a href="#">105TA5810</a>
	A	81	14,5	13	14,5	41,5	93,5	18	155	V	<a href="#">107TA9495</a>
	A	81	25	12	22	27	72,5	14	174	V	<a href="#">135TA1754</a>
	A	81,5	12,5	12,5	12,5	38	74	12	150	V	<a href="#">135TA1830</a>
	A	81,5	13	16	13	38	74	14	158	V	<a href="#">105TA5832</a>



REF [124TA6677](#)



REF [124TA6585](#)



REF [135TA1914](#)



REF [128TA3491](#)



REF [105TA5810](#)



REF [107TA9495](#)



REF [135TA1754](#)



REF [135TA1830](#)



REF [105TA5832](#)



# ALTERNATORS

For all our latest catalogue updates and company info: [www.tvh.com](http://www.tvh.com)



ALTERNATORS

used for: **YALE**

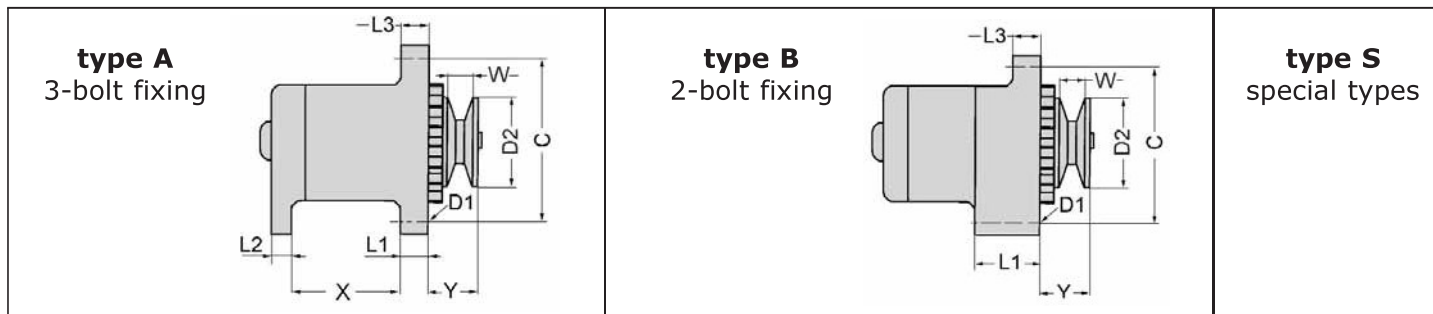

voltage (volt)	type	dimension (mm)	dimension (mm)	dimension (mm)	dimension (mm)	dimension (mm)	dimension (mm)	dimension (mm)	dimension (mm)	regulator	reference new
U	TY	X	L1	L2	L3	Y	D2	W	C	REG	
12	A	81,5	13,5	13	13	38	74	14	157	V	<a href="#">135TA1809</a>
	A	82	12,5	12,5	13	40	69	10	155	V	<a href="#">124TA6581</a>
	A	82	13	13	13	45	93,5	16,5	174	V	<a href="#">107TA9442</a>
	A	82,5	14	15	14				150	V	<a href="#">135TA1813</a>
	A	82,7	14	16	17,5				140	V	<a href="#">128TA3831</a>
	A	82,8	11,3	12,3	11,3	32	64	12	150	V	<a href="#">135TA1817</a>
	A	83	11	12	11				150	V	<a href="#">135TA1848</a>
	A	83	11	12,5	11	38	74	12	148	V	<a href="#">135TA1740</a>
	A	83	11	14	11				150	V	<a href="#">135TA1769</a>



# ALTERNATORS

For all our latest catalogue updates and company info: [www.tvh.com](http://www.tvh.com)

ALTERNATORS

used for: **YALE**

**type A**  
3-bolt fixing

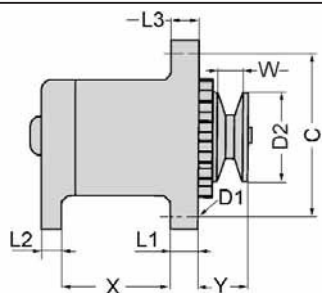

**type B**  
2-bolt fixing

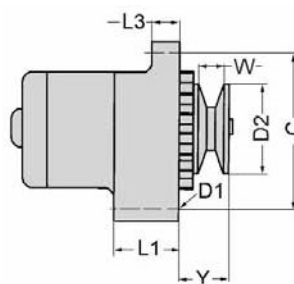

**type S**  
special types

voltage (volt)	type	dimension (mm)	dimension (mm)	dimension (mm)	dimension (mm)	dimension (mm)	dimension (mm)	dimension (mm)	dimension (mm)	regulator	reference new
U	TY	X	L1	L2	L3	Y	D2	W	C	REG	
12	A	83	11,3	12	11	38,5	83,5	15	150	V	<a href="#">135TA1846</a>
	A	83	11,3	12	11,3	32,5	81,5		149	V	<a href="#">135TA1815</a>
	A	83,3	11,2	11,5	11,3	32,5	63,8	12	148,5	V	<a href="#">135TA1787</a>
	A	83,5	11,5	12	11,2	33,4	74	12	150	V	<a href="#">135TA1820</a>
	A	98	13	13	12	64,5			174		<a href="#">105TA5813</a>
	B		16,6		14,2	51,5	65	14	132		<a href="#">135TA1790</a>
	B		21		16	32	62,8	11	138	V	<a href="#">135TA1882</a>
	B		21		16	33,5	70	14	154	V	<a href="#">128TA3850</a>
	B		27,5		16	42	76	14	175	V	<a href="#">106TA5132</a>



REF [135TA1846](#)



REF [135TA1815](#)



REF [135TA1787](#)



REF [135TA1820](#)



REF [105TA5813](#)



REF [135TA1790](#)



REF [135TA1882](#)



REF [128TA3850](#)



REF [106TA5132](#)





# ALTERNATORS

For all our latest catalogue updates and company info: [www.tvh.com](http://www.tvh.com)



ALTERNATORS

used for: **YALE**

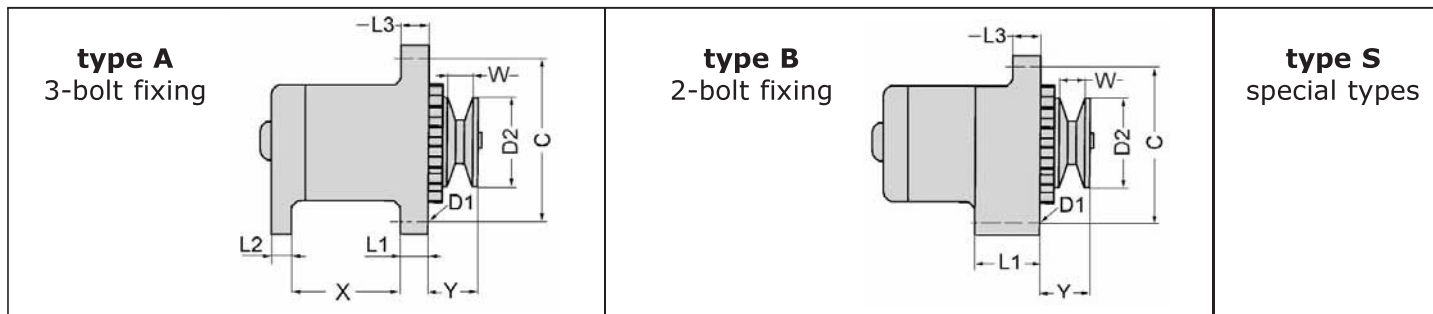

voltage (volt)	type	dimension (mm)	dimension (mm)	dimension (mm)	dimension (mm)	dimension (mm)	dimension (mm)	dimension (mm)	dimension (mm)	regulator	reference new
U	TY	X	L1	L2	L3	Y	D2	W	C	REG	
12	B		50,6		15,8				172	V	<a href="#">135TA2536</a>
	B		50,8		15,7				170	V	<a href="#">128TA3887</a>
	B		50,8		16	46,5	72	26,5	165	V	<a href="#">135TA1808</a>
	B		51		11,5				164	V	<a href="#">135TA1767</a>
	B		51		11,5				165	V	<a href="#">128TA3542</a>
	B		51		12	41	69	17,5	155		<a href="#">135TA1716</a>
	B		51		15				155	V	<a href="#">124TA6595</a>
	B		51		15	34	66	12	170	V	<a href="#">111TA1130</a>
	B		51		15,5				171		<a href="#">128TA3915</a>



# ALTERNATORS

For all our latest catalogue updates and company info: [www.tvh.com](http://www.tvh.com)

ALTERNATORS

used for: **YALE**

**type A**  
3-bolt fixing

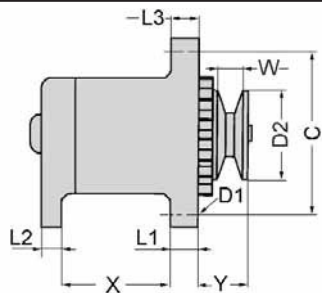

**type B**  
2-bolt fixing

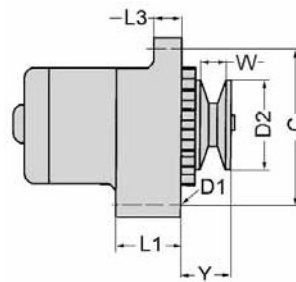

**type S**  
special types

voltage (volt)	type	dimension (mm)	dimension (mm)	dimension (mm)	dimension (mm)	dimension (mm)	dimension (mm)	dimension (mm)	dimension (mm)	regulator	reference new
U	TY	X	L1	L2	L3	Y	D2	W	C	REG	
12	B		51		16				165	V	<a href="#">135TA1692</a>
	B		51		16,2				171	V	<a href="#">128TA3558</a>
	B		51		16,4	44	67	23	165	V	<a href="#">124TA6686</a>
	B		51		16,5				167	V	<a href="#">136TA3827</a>
	B		51		16,5	45,5	61,5	24,3	137	V	<a href="#">124TA6605</a>
	B		51		16,6	49	69	25,3	165	V	<a href="#">124TA6694</a>
	B		51		17,5	34	65	12	168		<a href="#">136TA3774</a>
	B		56		16,5				173	V	<a href="#">128TA3567</a>
	B		58		16	54,5	56,5	23,5	152	V	<a href="#">128TA3932</a>



REF [135TA1692](#)



REF [128TA3558](#)



REF [124TA6686](#)



REF [136TA3827](#)



REF [124TA6605](#)



REF [124TA6694](#)



REF [136TA3774](#)



REF [128TA3567](#)



REF [128TA3932](#)



# ALTERNATORS

For all our latest catalogue updates and company info: [www.tvh.com](http://www.tvh.com)



ALTERNATORS

used for: **YALE**

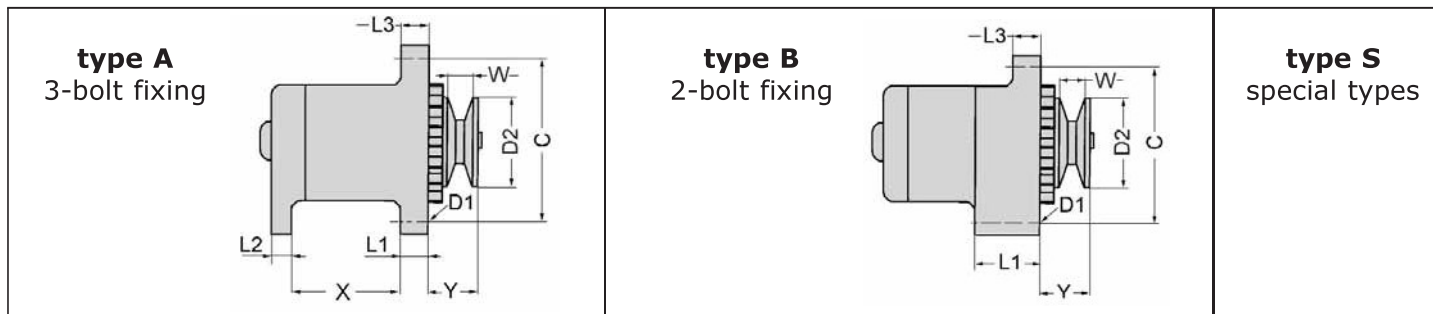

voltage (volt)	type	dimension (mm)	dimension (mm)	dimension (mm)	dimension (mm)	dimension (mm)	dimension (mm)	dimension (mm)	dimension (mm)	regulator	reference new
U	TY	X	L1	L2	L3	Y	D2	W	C	REG	
12	B		76,5		13,5	45	72	14	175	V	<a href="#">128TA3718</a>
24	A	80	13	12,5	13	55,5	84	31	174	V	<a href="#">135TA1697</a>
	A	82	14	14	14				159,6	V	<a href="#">135TA1792</a>
	A	96	14	14	14,2	48	85	16	175	V	<a href="#">110TA9055</a>
	A	101	14	13,5	14				198	V	<a href="#">136TA3835</a>
	A	101	14	13,5	14				198	V	<a href="#">124TA6704</a>
	B		77		21				184	V	<a href="#">135TA1806</a>



# ALTERNATORS

For all our latest catalogue updates and company info: [www.tvh.com](http://www.tvh.com)

ALTERNATORS

## complete range

**type A**  
3-bolt fixing

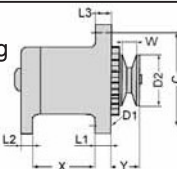

**type B**  
2-bolt fixing

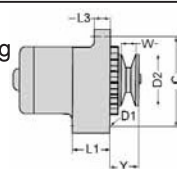

voltage (volt)	type	dimension (mm) X	dimension (mm) L1	dimension (mm) L2	dimension (mm) L3	dimension (mm) Y	dimension (mm) C	regulator REG	reference new	for picture see make
12	A	23	13	16	13	39	155	V	<a href="#">135TA1893</a>	MITSUBISHI-CATERPILLAR
12	A	40,3	17	10,5	13	35	148	V	<a href="#">124TA6736</a>	MITSUBISHI-CATERPILLAR
12	A	40,5	17	12,5	13	33	145	V	<a href="#">135TA1746</a>	MOFFETT
12	A	40,6	17	13,3	13	40	150	V	<a href="#">128TA3728</a>	MITSUBISHI-CATERPILLAR
12	A	41	16,5	13	13	33,5	145	V	<a href="#">128TA3573</a>	YALE
12	A	47	13	13	13	39	153		<a href="#">107TA9456</a>	MITSUBISHI-CATERPILLAR
12	A	47	13	13,4	13	39	155	V	<a href="#">105TA5709</a>	MITSUBISHI-CATERPILLAR
12	A	47	24	20	12,4	40	155		<a href="#">128TA3750</a>	MITSUBISHI-CATERPILLAR
12	A	47,2	12,8	13	13	39,5	155	V	<a href="#">124TA6696</a>	MITSUBISHI-CATERPILLAR
12	A	48	13	13	13	37	177	V	<a href="#">105TA5524</a>	MITSUBISHI-CATERPILLAR
12	A	48	13	13	13	39	153	V	<a href="#">105TA5512</a>	MITSUBISHI-CATERPILLAR
12	A	48	13	13	13	40	153	V	<a href="#">124TA6625</a>	MITSUBISHI-CATERPILLAR
12	A	48,2	12,8	12,8	12,8	36,5	154	V	<a href="#">105TA5517</a>	MITSUBISHI-CATERPILLAR
12	A	53	14	13	13		174		<a href="#">105TA5691</a>	MITSUBISHI-CATERPILLAR
12	A	53,5	14	12,5	12,5	38	174		<a href="#">128TA3556</a>	MITSUBISHI-CATERPILLAR
12	A	53,5	14	13	13	38	175	V	<a href="#">105TA5526</a>	MITSUBISHI-CATERPILLAR
12	A	54,5	13	14,5	13	43	180	V	<a href="#">107TA9437</a>	MITSUBISHI-CATERPILLAR
12	A	54,8	13	13	13		173		<a href="#">136TA3844</a>	HYUNDAI
12	A	55	13	13	13	39	174	V	<a href="#">105TA5698</a>	MITSUBISHI-CATERPILLAR
12	A	55,2	13	13	13	35	174	V	<a href="#">135TA1892</a>	MITSUBISHI-CATERPILLAR
12	A	57	23,5	16,2	23,2	37	100	V	<a href="#">105TA5560</a>	OM PIMESPO
12	A	58	13	13	36,4	33	172	V	<a href="#">124TA6728</a>	CLARK-SAMSUNG
12	A	60,5	17	21,5	17		166		<a href="#">105TA5568</a>	OM PIMESPO
12	A	63	16	16	16	36	166	V	<a href="#">128TA3540</a>	OM PIMESPO
12	A	63	17	16	15		166	V	<a href="#">105TA5562</a>	OM PIMESPO
12	A	63,5	15	16	15		165	V	<a href="#">105TA5564</a>	OM PIMESPO
12	A	63,5	17	22	15		167		<a href="#">105TA5558</a>	OM PIMESPO
12	A	64	16	16	15,5	37	162,5	V	<a href="#">103TA3675</a>	OM PIMESPO
12	A	64,5	16,5	12	16,5	47,5	155	V	<a href="#">128TA3857</a>	YALE
12	A	64,5	16,5	16	15		166	V	<a href="#">124TA6613</a>	STILL
12	A	64,8	15	13	13	18,5	155	V	<a href="#">135TA1930</a>	BOBCAT
12	A	65	13	12	13,5	41,5	155	V	<a href="#">103TA3719</a>	TOYOTA
12	A	65	13,5	15,5	13	44,5	175		<a href="#">124TA6660</a>	NISSAN
12	A	65	17	16	15	50	165	V	<a href="#">105TA5569</a>	OM PIMESPO
12	A	65	17,2	16	15,5	48	165	V	<a href="#">128TA3935</a>	OM PIMESPO
12	A	65	27	15	10	30	168	V	<a href="#">116TA7366</a>	DESTA
12	A	65,5	13	12	12,5	36	150		<a href="#">135TA1862</a>	MOFFETT
12	A	65,5	13	14	13	40	175		<a href="#">135TA1744</a>	YALE
12	A	65,5	27	4	11	38	162	V	<a href="#">135TA1888</a>	KOMATSU
12	A	66	27	4	11	29	162	V	<a href="#">124TA6727</a>	STILL
12	A	66	27	4	11	30	163	V	<a href="#">128TA3852</a>	FENWICK & PEG
12	A	66	27,3	4	11,2	29	162	V	<a href="#">116TA7357</a>	FENWICK & PEG
12	A	66,5	12	12	12	39	142	V	<a href="#">128TA3513</a>	MITSUBISHI-CATERPILLAR
12	A	66,5	20	12	16	34	155	V	<a href="#">103TA3763</a>	MITSUBISHI-CATERPILLAR
12	A	66,5	20,5	12	16	32,5	157	V	<a href="#">124TA6648</a>	MITSUBISHI-CATERPILLAR

# ALTERNATORS

For all our latest catalogue updates and company info: [www.tvh.com](http://www.tvh.com)



## complete range

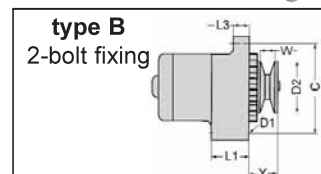
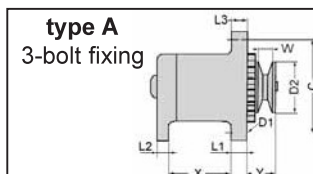

ALTERNATORS

voltage (volt)	type	dimension (mm) X	dimension (mm) L1	dimension (mm) L2	dimension (mm) L3	dimension (mm) Y	dimension (mm) C	regulator REG	reference new	for picture see make
12	A	66,6	13,2	12,7	13,2	43	175	V	<a href="#">135TA1797</a>	MITSUBISHI-CATERPILLAR
12	A	67	12,5	12,5	12	41,5	168		<a href="#">128TA3610</a>	TOYOTA
12	A	67	15	12	15	45,5	168	V	<a href="#">105TA5804</a>	TOYOTA
12	A	67	15	12,3	15	39	168		<a href="#">103TA3677</a>	TOYOTA
12	A	67	15	13	15	38,5	170	V	<a href="#">124TA6691</a>	TOYOTA
12	A	67	18	13	14	47	156	V	<a href="#">135TA1937</a>	BAUMANN
12	A	67	19,8	15,4	12	32,2	154	V	<a href="#">136TA3797</a>	UPRIGHT
12	A	67	20	12	16	34	155	V	<a href="#">124TA6634</a>	TOYOTA
12	A	67	20	12	16	40	156	V	<a href="#">128TA3943</a>	TOYOTA
12	A	67	20	12	16	41	156	V	<a href="#">135TA1739</a>	YALE
12	A	67	20	12	16	42	155	V	<a href="#">135TA1726</a>	YALE
12	A	67,3	12	11,6	12	39	156		<a href="#">135TA1801</a>	TCM
12	A	67,3	20	12	16,3	32,5	155,5	V	<a href="#">128TA3668</a>	TOYOTA
12	A	67,5	12	12,5	12	48	168	V	<a href="#">124TA6684</a>	TOYOTA
12	A	67,5	20	12,5	16	40	155	V	<a href="#">128TA3515</a>	TOYOTA
12	A	68	12	11,6	12	45	143	V	<a href="#">128TA3700</a>	TCM
12	A	68	12	12	12	38,8	150	V	<a href="#">135TA1851</a>	OM PIMESPO
12	A	68,5	13	13	13	39	154	V	<a href="#">128TA3617</a>	OM PIMESPO
12	A	69	27	12	11	29,5	141	V	<a href="#">103TA3653</a>	FENWICK & PEG
12	A	69	27	21,5	11	41	170	V	<a href="#">124TA6667</a>	LINDE-LANSING
12	A	70	15,5	16	16	56,5	190	V	<a href="#">103TA3726</a>	KOMATSU
12	A	70	25	11,5	25	36	163	V	<a href="#">135TA1866</a>	NISSAN
12	A	70	27	13,5	11	44	160	V	<a href="#">103TA3811</a>	COVENTRY CLIMAX
12	A	70,3	16	16	16	51	190	V	<a href="#">124TA6685</a>	KOMATSU
12	A	70,8	17	12	18		164	V	<a href="#">103TA3684</a>	OM PIMESPO
12	A	71,3	27,1	20	11	37,5	171	V	<a href="#">124TA6678</a>	STILL
12	A	72	13	13	13	44	167	V	<a href="#">124TA6735</a>	MITSUBISHI-CATERPILLAR
12	A	73	17	12	18	35,5	164	V	<a href="#">105TA5565</a>	OM PIMESPO
12	A	75,2	12	12	12	48	170	V	<a href="#">124TA6744</a>	TOYOTA
12	A	75,2	12	12	12,4	39	171		<a href="#">128TA3583</a>	TOYOTA
12	A	75,3	17	12	18	35	166	V	<a href="#">135TA1946</a>	OM PIMESPO
12	A	75,5	12	12	12	42	180		<a href="#">105TA5800</a>	TOYOTA
12	A	76	12,5	12	12	41,5	166	V	<a href="#">105TA5794</a>	TOYOTA
12	A	77	12	11,5	12	47	170		<a href="#">103TA3795</a>	TOYOTA
12	A	78	12,8	13	13	39	175	V	<a href="#">124TA6584</a>	YALE
12	A	78,5	13	16,5	13	39	175	V	<a href="#">135TA1912</a>	TCM
12	A	79	13,4	15,3	24	58	165	V	<a href="#">107TA9475</a>	MITSUBISHI-CATERPILLAR
12	A	79,8	13	13	13	50	155	V	<a href="#">116TA7281</a>	TCM
12	A	80	13	12,7	13,2	39	157		<a href="#">135TA1867</a>	NISSAN
12	A	80	13	12,8	13,5	40	155	V	<a href="#">124TA6698</a>	NISSAN
12	A	80	13	13	12	39,5	175	V	<a href="#">135TA1891</a>	MITSUBISHI-CATERPILLAR
12	A	80	13	13	13	37	155	V	<a href="#">103TA3781</a>	TCM
12	A	80	13	13	13	38	175	V	<a href="#">105TA5817</a>	YALE
12	A	80	13	13	13	38	170	V	<a href="#">105TA5733</a>	NISSAN
12	A	80	13	13	13	38,5	175	V	<a href="#">135TA1742</a>	JCB

# ALTERNATORS

For all our latest catalogue updates and company info: [www.tvh.com](http://www.tvh.com)

ALTERNATORS

## complete range

**type A**  
3-bolt fixing

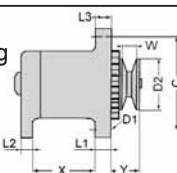

**type B**  
2-bolt fixing

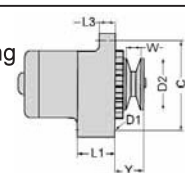

voltage (volt)	type	dimension (mm) X	dimension (mm) L1	dimension (mm) L2	dimension (mm) L3	dimension (mm) Y	dimension (mm) C	regulator REG	reference new	for picture see make
12	A	80	13	13	13	38,5	156	V	<a href="#">124TA6710</a>	TCM
12	A	80	13	13	13	39	155	V	<a href="#">105TA5786</a>	TCM
12	A	80	13	13	13	39,3	157	V	<a href="#">135TA1775</a>	YALE
12	A	80	13	13	13	40	155	V	<a href="#">128TA3613</a>	mitsubishi-caterpillar
12	A	80	13	13	13	42	155	V	<a href="#">128TA3815</a>	TCM
12	A	80	13	13	13	44	155	V	<a href="#">128TA3644</a>	TCM
12	A	80	13	13	13	45	155	V	<a href="#">105TA5779</a>	TCM
12	A	80	13	13	13	45,5	155	V	<a href="#">105TA5666</a>	mitsubishi-caterpillar
12	A	80	13	13	13		155		<a href="#">136TA3857</a>	TCM
12	A	80	13	13	13,5	36,5	155		<a href="#">135TA1714</a>	TCM
12	A	80	13	13	14	40	175	V	<a href="#">116TA7336</a>	mitsubishi-caterpillar
12	A	80	13	14	13	38,5	175	V	<a href="#">105TA5783</a>	TCM
12	A	80	13	14	22	46,5	169	V	<a href="#">135TA1865</a>	NISSAN
12	A	80	13	20	13	46	168	V	<a href="#">135TA1929</a>	HELI
12	A	80	13,5	13	13	35,5	172	V	<a href="#">105TA5776</a>	TCM
12	A	80	13,5	13	13	37	175	V	<a href="#">105TA5887</a>	mitsubishi-caterpillar
12	A	80	13,5	15	13	42	155	V	<a href="#">128TA3898</a>	mitsubishi-caterpillar
12	A	80,1	13,1	13,1	13,1	40	155		<a href="#">135TA1698</a>	YALE
12	A	80,3	13	12,2	13	38,3	174	V	<a href="#">105TA5523</a>	mitsubishi-caterpillar
12	A	80,4	13	13	13	54	175	V	<a href="#">135TA1796</a>	TCM
12	A	80,5	13	12,8	13	43,5	174	V	<a href="#">106TA5146</a>	HYUNDAI
12	A	80,5	13	13	13	37	155		<a href="#">108TA8287</a>	TCM
12	A	80,5	13	13	13	37,5	175	V	<a href="#">124TA6676</a>	linde-lansing
12	A	80,5	13	13	13	38	170	V	<a href="#">116TA7359</a>	mitsubishi-caterpillar
12	A	80,5	13	13	13	39	173	V	<a href="#">116TA7354</a>	HYSTER
12	A	80,5	13	13	13	40	156	V	<a href="#">128TA3902</a>	TCM
12	A	80,5	13	13	13	40	174	V	<a href="#">136TA3788</a>	TCM
12	A	80,5	13	13	13	40,5	175	V	<a href="#">124TA6738</a>	TCM
12	A	80,5	13	13	13	55,5	175	V	<a href="#">128TA3911</a>	NISSAN
12	A	80,5	13	13	13	56	172	V	<a href="#">103TA3655</a>	NISSAN
12	A	80,5	13	13	13,5	57	175,5	V	<a href="#">124TA6649</a>	TCM
12	A	80,5	13	13,5	13	40	155	V	<a href="#">124TA6677</a>	YALE
12	A	80,5	13	13,5	13,5	39	174	V	<a href="#">105TA5731</a>	NISSAN
12	A	80,5	13,5	13	13,5	53,5	155		<a href="#">105TA5778</a>	TCM
12	A	80,5	13,5	13,5	13	40	155	V	<a href="#">124TA6585</a>	YALE
12	A	80,5	14	20	14		149		<a href="#">135TA1914</a>	YALE
12	A	80,5	14,5	13,5	14,5	37	157	V	<a href="#">128TA3491</a>	YALE
12	A	80,7	13	13	13	39	174,5		<a href="#">135TA1943</a>	TCM
12	A	80,8	13	13	13	57	175	V	<a href="#">116TA7348</a>	NISSAN
12	A	80,8	14,3	19,8	14,2	46	129	V	<a href="#">128TA3892</a>	JCB
12	A	81	10	15	10,5	33	147,5	V	<a href="#">136TA3856</a>	JUNGHEINRICH-STEINBOCK
12	A	81	12	12	12	40	155	V	<a href="#">116TA7349</a>	TOYOTA
12	A	81	12	12	12	45	170	V	<a href="#">107TA9452</a>	TCM
12	A	81	12	12,5	12,5	39	180	V	<a href="#">105TA5774</a>	TCM
12	A	81	13	13	13	37	175	V	<a href="#">135TA1879</a>	NISSAN

# ALTERNATORS

For all our latest catalogue updates and company info: [www.tvh.com](http://www.tvh.com)



ALTERNATORS

## complete range

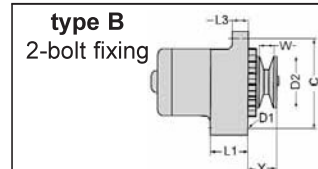
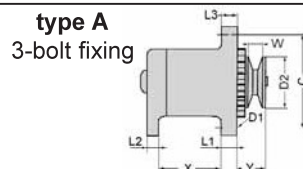

voltage (volt)	type	dimension (mm) X	dimension (mm) L1	dimension (mm) L2	dimension (mm) L3	dimension (mm) Y	dimension (mm) C	regulator REG	reference new	for picture see make
12	A	81	13	13	13	38	175,5		<a href="#">135TA1899</a>	mitsubishi-caterpillar
12	A	81	13	13	13	38,5	175	V	<a href="#">124TA6732</a>	NISSAN
12	A	81	13	13	13	43,8	155	V	<a href="#">105TA5810</a>	YALE
12	A	81	13	13	13	57	175	V	<a href="#">136TA3849</a>	TCM
12	A	81	14	20	14	46	128	V	<a href="#">128TA3894</a>	JCB
12	A	81	14	20	18		140	V	<a href="#">128TA3766</a>	MANITOU
12	A	81	14,5	13	14,5	41,5	155	V	<a href="#">107TA9495</a>	YALE
12	A	81	15	13,5	14	36,5	155	V	<a href="#">103TA3812</a>	NISSAN
12	A	81	25	12	22	27	174	V	<a href="#">135TA1754</a>	YALE
12	A	81	56,5	20	56,5	32	147	V	<a href="#">105TA5554</a>	FENWICK & PEG
12	A	81,5	10,4	10	10		143	V	<a href="#">107TA9490</a>	MANITOU
12	A	81,5	11	12	11	32	148	V	<a href="#">107TA9447</a>	MANITOU
12	A	81,5	12	13	12	37,2	149	V	<a href="#">128TA3773</a>	JCB
12	A	81,5	12	13	12	44	146	V	<a href="#">128TA3746</a>	HYUNDAI
12	A	81,5	12,4	15,2	23,5	56,5	163	V	<a href="#">124TA6647</a>	CLARK-SAMSUNG
12	A	81,5	12,5	12,5	12,5	38	150	V	<a href="#">135TA1830</a>	YALE
12	A	81,5	13	13	13	40	174	V	<a href="#">105TA5895</a>	NISSAN
12	A	81,5	13	13	13	66	177	V	<a href="#">116TA7382</a>	NISSAN
12	A	81,5	13	16	13	37	156	V	<a href="#">136TA3870</a>	mitsubishi-caterpillar
12	A	81,5	13	16	13	38	158	V	<a href="#">105TA5832</a>	YALE
12	A	81,5	13,5	13	13	38	157	V	<a href="#">135TA1809</a>	YALE
12	A	82	10	20	10	43	144	V	<a href="#">136TA3847</a>	mitsubishi-caterpillar
12	A	82	11	20	11	34	149	V	<a href="#">135TA1922</a>	KALMAR
12	A	82	11	20,5	11		150	V	<a href="#">136TA3866</a>	JCB
12	A	82	11,5	11,4	11,5		148	V	<a href="#">135TA1884</a>	STILL
12	A	82	12,5	12,5	13	40	155	V	<a href="#">124TA6581</a>	YALE
12	A	82	13	13	12	40,7	176	V	<a href="#">105TA5582</a>	HYSTER
12	A	82	13	13	13	23	175		<a href="#">136TA3842</a>	KOMATSU
12	A	82	13	13	13	45	174	V	<a href="#">107TA9442</a>	YALE
12	A	82	13	13	13	56	175	V	<a href="#">105TA5729</a>	NISSAN
12	A	82,5	13	13	13	39,5	175	V	<a href="#">116TA7386</a>	mitsubishi-caterpillar
12	A	82,5	13	13	13	42	155	V	<a href="#">107TA9450</a>	TCM
12	A	82,5	14	13,5	14	55	165	V	<a href="#">136TA3854</a>	DIECI
12	A	82,5	14	15	14		150	V	<a href="#">135TA1813</a>	YALE
12	A	82,5	14	16	17	34	140	V	<a href="#">136TA3859</a>	JLG
12	A	82,5	14	16	17	34	140	V	<a href="#">128TA3929</a>	BOBCAT
12	A	82,5	14,3	15,8	17,7	33,8	140		<a href="#">135TA1852</a>	MANITOU
12	A	82,5	14,5	15	14,5		150	V	<a href="#">135TA1844</a>	MANITOU
12	A	82,5	18	15	16		141	V	<a href="#">136TA3848</a>	MANITOU
12	A	82,5	25	12,5	22,5	35,5	163	V	<a href="#">105TA5693</a>	mitsubishi-caterpillar
12	A	82,7	13	13	13	42,5	158	V	<a href="#">109TA5983</a>	TCM
12	A	82,7	14	16	17		140	V	<a href="#">128TA3819</a>	MANITOU
12	A	82,7	14	16	17,5		140	V	<a href="#">128TA3831</a>	YALE
12	A	82,8	11,3	12,3	11,3	32	150	V	<a href="#">135TA1817</a>	YALE
12	A	83	9	20	9,5		143	V	<a href="#">135TA1921</a>	CLARK-SAMSUNG

# ALTERNATORS

For all our latest catalogue updates and company info: [www.tvh.com](http://www.tvh.com)

ALTERNATORS

## complete range

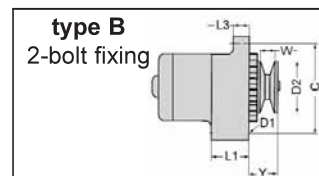
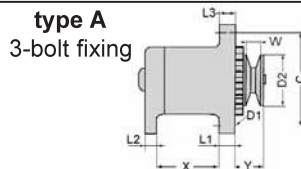

voltage (volt)	type	dimension (mm) X	dimension (mm) L1	dimension (mm) L2	dimension (mm) L3	dimension (mm) Y	dimension (mm) C	regulator REG	reference new	for picture see make
U	TY									
12	A	83	10	10	10	34	144	V	<a href="#">103TA3786</a>	BALKANCAR
12	A	83	11	12	11		149	V	<a href="#">135TA1923</a>	MOFFETT
12	A	83	11	12	11		150	V	<a href="#">135TA1848</a>	YALE
12	A	83	11	12,5	11	38	148	V	<a href="#">135TA1740</a>	YALE
12	A	83	11	14	11		150	V	<a href="#">135TA1769</a>	YALE
12	A	83	11,3	12	11	38,5	150	V	<a href="#">135TA1846</a>	YALE
12	A	83	11,3	12	11,3	32,5	149	V	<a href="#">135TA1815</a>	YALE
12	A	83,3	11,2	11,5	11,3	32,5	148,5	V	<a href="#">135TA1787</a>	YALE
12	A	83,5	11	11,5	11,5	34,5	148	V	<a href="#">105TA5655</a>	MANITOU
12	A	83,5	11,5	12	11,2	33,4	150	V	<a href="#">135TA1820</a>	YALE
12	A	83,5	12	12	12,4	33	148	V	<a href="#">128TA3795</a>	SAMBRO
12	A	84	12	12	12	41	148	V	<a href="#">135TA1932</a>	MANITOU
12	A	84	12,4	12	12,5		150	V	<a href="#">128TA3818</a>	JCB
12	A	84,5	10,5	10,5	10,5		148	V	<a href="#">124TA6700</a>	LINDE-LANSING
12	A	84,6	10,6	10,8	10,6	35,5	149	V	<a href="#">135TA1887</a>	MANITOU
12	A	85	10,5	10	10,5	37	152	V	<a href="#">103TA3698</a>	MITSUBISHI-CATERPILLAR
12	A	85,3	14,2	14,2	14,2	78,5	224		<a href="#">135TA1881</a>	JCB
12	A	87	9,8	20	9,5		143	V	<a href="#">128TA3939</a>	BAUMANN
12	A	87,5	9,8	10	10		142	V	<a href="#">135TA1794</a>	JCB
12	A	88	9	10,5	9,5		142	V	<a href="#">105TA5511</a>	MITSUBISHI-CATERPILLAR
12	A	88	10	20	10	37	144	V	<a href="#">135TA1947</a>	JUNGHEINRICH-STEINBOCK
12	A	88,5	9,2	10	9		143	V	<a href="#">107TA9430</a>	LINDE-LANSING
12	A	98	10,5	10	10,8	42	157	V	<a href="#">124TA6682</a>	TCM
12	A	98	12,5	12	12	37,5	155		<a href="#">103TA3745</a>	NISSAN
12	A	98	13	10	12	38	150		<a href="#">105TA5761</a>	TCM
12	A	98	13	10	13,5	41	158	V	<a href="#">135TA1717</a>	SALEV
12	A	98	13	13	12	64,5	174		<a href="#">105TA5813</a>	YALE
12	A	98	13	13	13	48	174	V	<a href="#">105TA5781</a>	TCM
12	A	98,3	13	13	13	39	173	V	<a href="#">128TA3840</a>	NISSAN
12	A	98,5	12	13	12	41	155	V	<a href="#">124TA6681</a>	TCM
12	A	98,5	13	10	13,5	36,5	155	V	<a href="#">105TA5757</a>	TCM
12	A	99,5	14	15	12,2	52	170		<a href="#">107TA9502</a>	TCM
12	A	100	12,5	14	14		218	V	<a href="#">105TA5520</a>	MITSUBISHI-CATERPILLAR
12	A	101	14	20	14		198	V	<a href="#">136TA3845</a>	KALMAR
12	A	101,5	14,5	14	14,5		215	V	<a href="#">103TA3784</a>	HYSTER
12	A	101,8	14,5	20	14,5		196	V	<a href="#">128TA3910</a>	MITSUBISHI-CATERPILLAR
12	A	102	13,5	13,5	14		200		<a href="#">124TA6743</a>	MITSUBISHI-CATERPILLAR
12	A	102	14	13,5	14		215	V	<a href="#">103TA3658</a>	HYSTER
12	A	105	14,2	14,5	14	47	170	V	<a href="#">124TA6730</a>	TOYOTA
12	A	105,5	14	15	14	47,5	175	V	<a href="#">103TA3778</a>	TOYOTA
12	A	181	9	10	9		156		<a href="#">105TA5536</a>	CLARK-SAMSUNG
12	B	68	27	9,5	11	38,5	169	V	<a href="#">107TA9549</a>	LINDE-LANSING
12	B		15		13	39	155,5	V	<a href="#">135TA1873</a>	TCM
12	B		16,6		14,2	51,5	132		<a href="#">135TA1790</a>	YALE
12	B		21		16	31	155	V	<a href="#">128TA3940</a>	TCM



# ALTERNATORS

For all our latest catalogue updates and company info: [www.tvh.com](http://www.tvh.com)



## complete range

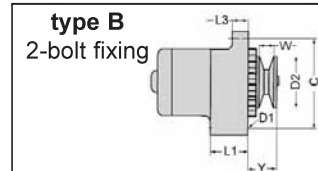
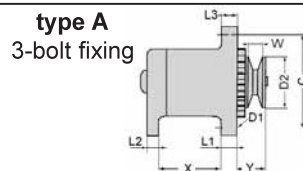

ALTERNATORS

voltage (volt)	type	dimension (mm) X	dimension (mm) L1	dimension (mm) L2	dimension (mm) L3	dimension (mm) Y	dimension (mm) C	regulator REG	reference new	for picture see make
U	TY									
12	B		21		16	32	138	V	<a href="#">135TA1882</a>	YALE
12	B		21		16	32	154	V	<a href="#">136TA3850</a>	KOMATSU
12	B		21		16	33,5	154	V	<a href="#">128TA3850</a>	YALE
12	B		21		16	35	152	V	<a href="#">136TA3837</a>	MOFFETT
12	B		21		16	35	154	V	<a href="#">135TA1916</a>	MOFFETT
12	B		21		16	35	138	V	<a href="#">105TA5775</a>	TCM
12	B		21		16	35	155	V	<a href="#">103TA3819</a>	TOYOTA
12	B		21		16	35,5	155	V	<a href="#">107TA9550</a>	TOYOTA
12	B		21		16	39	155	V	<a href="#">135TA1826</a>	mitsubishi-caterpillar
12	B		21,2		16	31	155	V	<a href="#">116TA7350</a>	TOYOTA
12	B		21,3		15,5	35	138	V	<a href="#">124TA6740</a>	TCM
12	B		21,3		16	33	147	V	<a href="#">135TA1843</a>	HYUNDAI
12	B		21,5		16	32	140	V	<a href="#">128TA3522</a>	TOYOTA
12	B		23,4		16,6	32	138	V	<a href="#">135TA1945</a>	TOYOTA
12	B		23,5		16	32	138	V	<a href="#">135TA2472</a>	TCM
12	B		23,5		16,5	31,5	137	V	<a href="#">124TA6697</a>	TOYOTA
12	B		24		16	30,5	138	V	<a href="#">136TA8347</a>	TCM
12	B		24		16	33	140	V	<a href="#">135TA1877</a>	HELI
12	B		24		16,5	30,5	138	V	<a href="#">128TA3511</a>	TOYOTA
12	B		24		16,5	31	140	V	<a href="#">117TA8564</a>	TOYOTA
12	B		24,2		16	30	140	V	<a href="#">124TA6692</a>	TCM
12	B		24,2		16	30	137	V	<a href="#">128TA3930</a>	JLG
12	B		24,4		15,8	57	138	V	<a href="#">136TA3802</a>	UPRIGHT
12	B		27		11	33,5	160	V	<a href="#">135TA1903</a>	STILL
12	B		27		11		161	V	<a href="#">135TA1745</a>	STILL
12	B		27		11,5		165	V	<a href="#">103TA3721</a>	TENNANT
12	B		27,5		16	42	175	V	<a href="#">106TA5132</a>	YALE
12	B		29		17	43	157	V	<a href="#">135TA1926</a>	TOYOTA
12	B		29		17	45	155	V	<a href="#">128TA3913</a>	TCM
12	B		32,2		32	33	115	V	<a href="#">105TA5563</a>	OM PIMESPO
12	B		50,5		16,5	36	165,5	V	<a href="#">107TA9493</a>	CLARK-SAMSUNG
12	B		50,6		15,8		172	V	<a href="#">135TA2536</a>	YALE
12	B		50,7		15,7	33,5	167	V	<a href="#">128TA3838</a>	CLARK-SAMSUNG
12	B		50,7		16,5	52,5	165	V	<a href="#">116TA7405</a>	HYSTER
12	B		50,8		15,7		170	V	<a href="#">128TA3887</a>	YALE
12	B		50,8		16	33	165		<a href="#">128TA3816</a>	CLARK-SAMSUNG
12	B		50,8		16	46,5	165	V	<a href="#">135TA1808</a>	YALE
12	B		50,8		16		170	V	<a href="#">135TA1871</a>	HYSTER
12	B		50,8		16,2	33	167	V	<a href="#">128TA3812</a>	mitsubishi-caterpillar
12	B		50,8		16,2		172	V	<a href="#">135TA1827</a>	MANITOU
12	B		50,8		16,5	34	166	V	<a href="#">135TA1799</a>	TENNANT
12	B		51		11,2		166	V	<a href="#">128TA3847</a>	CLARK-SAMSUNG
12	B		51		11,5		164	V	<a href="#">135TA1767</a>	YALE
12	B		51		11,5		165	V	<a href="#">128TA3542</a>	YALE
12	B		51		11,5		166	V	<a href="#">105TA5534</a>	CLARK-SAMSUNG

# ALTERNATORS

For all our latest catalogue updates and company info: [www.tvh.com](http://www.tvh.com)

ALTERNATORS

## complete range

**type A**  
3-bolt fixing

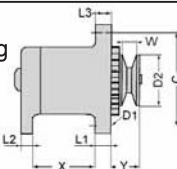

**type B**  
2-bolt fixing

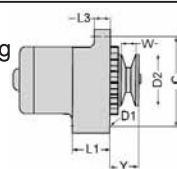

voltage (volt)	type	dimension (mm) X	dimension (mm) L1	dimension (mm) L2	dimension (mm) L3	dimension (mm) Y	dimension (mm) C	regulator REG	reference new	for picture see make
12	B		51		12	41	155		<a href="#">135TA1716</a>	YALE
12	B		51		15	34	170	V	<a href="#">111TA1130</a>	YALE
12	B		51		15		155	V	<a href="#">124TA6595</a>	YALE
12	B		51		15,5		171		<a href="#">128TA3915</a>	YALE
12	B		51		16		165	V	<a href="#">135TA1692</a>	YALE
12	B		51		16		170	V	<a href="#">136TA3869</a>	NISSAN
12	B		51		16,2	32,5	172	V	<a href="#">128TA3864</a>	JCB
12	B		51		16,2		171	V	<a href="#">128TA3558</a>	YALE
12	B		51		16,3		173	V	<a href="#">135TA1854</a>	TOYOTA
12	B		51		16,4	44	165	V	<a href="#">124TA6686</a>	YALE
12	B		51		16,5	32	172	V	<a href="#">136TA3811</a>	mitsubishi-caterpillar
12	B		51		16,5	33	165	V	<a href="#">128TA3827</a>	OM PIMESPO
12	B		51		16,5	34	168	V	<a href="#">105TA5507</a>	mitsubishi-caterpillar
12	B		51		16,5	45,5	137	V	<a href="#">124TA6605</a>	YALE
12	B		51		16,5		167	V	<a href="#">136TA3827</a>	YALE
12	B		51		16,6	49	165	V	<a href="#">124TA6694</a>	YALE
12	B		51		17,5	32	167	V	<a href="#">128TA3920</a>	CLARK-SAMSUNG
12	B		51		17,5	34	168		<a href="#">136TA3774</a>	YALE
12	B		51		17,5	37,5	167	V	<a href="#">135TA1876</a>	mitsubishi-caterpillar
12	B		51		25,5		178	V	<a href="#">124TA6714</a>	KALMAR
12	B		51		51	46	138	V	<a href="#">136TA3861</a>	mitsubishi-caterpillar
12	B		52		17	43,5	165	V	<a href="#">135TA1752</a>	TCM
12	B		55,5		13	55	175	V	<a href="#">116TA7374</a>	STILL
12	B		56		10	28	144	V	<a href="#">105TA5752</a>	STILL
12	B		56		10	33	138	V	<a href="#">128TA3691</a>	LINDE-LANSING
12	B		56		10	45	143,5	V	<a href="#">135TA1901</a>	OM PIMESPO
12	B		56		10	64	142	V	<a href="#">128TA3841</a>	LINDE-LANSING
12	B		56		10		143	V	<a href="#">128TA3534</a>	NISSAN
12	B		56		10		144	V	<a href="#">124TA6628</a>	SAMBRON
12	B		56		10		144	V	<a href="#">109TA5984</a>	KOMATSU
12	B		56		10,3	27,5	144	V	<a href="#">107TA9551</a>	LINDE-LANSING
12	B		56		14	53,5	173	V	<a href="#">105TA5749</a>	STILL
12	B		56		16,3	27,5	173	V	<a href="#">135TA1728</a>	CLARK-SAMSUNG
12	B		56		16,5		173	V	<a href="#">128TA3567</a>	YALE
12	B		56		19,3	66,5	155	V	<a href="#">135TA1864</a>	LINDE-LANSING
12	B		56		56		155	V	<a href="#">135TA1835</a>	LINDE-LANSING
12	B		56		56		155	V	<a href="#">135TA1954</a>	LINDE-LANSING
12	B		56		56		156	V	<a href="#">135TA1875</a>	SAMBRON
12	B		56		56		156	V	<a href="#">136TA3800</a>	STILL
12	B		56,2		20	61	155	V	<a href="#">128TA3933</a>	O&K
12	B		56,5		16,4	28,8	170	V	<a href="#">105TA5540</a>	CLARK-SAMSUNG
12	B		57,5		16	44	165	V	<a href="#">135TA1878</a>	TCM
12	B		57,5		16	48	161	V	<a href="#">105TA5796</a>	TOYOTA
12	B		57,5		22	57	160	V	<a href="#">128TA3753</a>	TOYOTA
12	B		58	16	0	48	163	V	<a href="#">136TA3855</a>	TOYOTA

# ALTERNATORS

For all our latest catalogue updates and company info: [www.tvh.com](http://www.tvh.com)



ALTERNATORS

## complete range

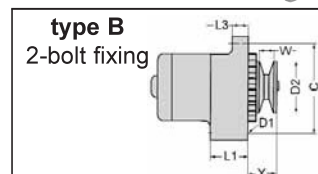
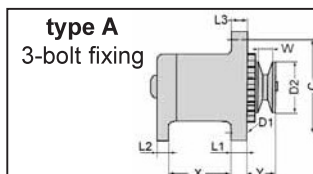

voltage (volt)	type	dimension (mm) X	dimension (mm) L1	dimension (mm) L2	dimension (mm) L3	dimension (mm) Y	dimension (mm) C	regulator REG	reference new	for picture see make
12	B		58		15,6	47	150	V	<a href="#">105TA5801</a>	TOYOTA
12	B		58		15,8	58,5	150	V	<a href="#">116TA7375</a>	TOYOTA
12	B		58		16	36,5	164	V	<a href="#">135TA1917</a>	TOYOTA
12	B		58		16	45	165	V	<a href="#">135TA1952</a>	TOYOTA
12	B		58		16	46	165	V	<a href="#">135TA1868</a>	TOYOTA
12	B		58		16	47,5	163	V	<a href="#">105TA5806</a>	TOYOTA
12	B		58		16	51	164,5	V	<a href="#">124TA6652</a>	TOYOTA
12	B		58		16	53	165	V	<a href="#">107TA9507</a>	TOYOTA
12	B		58		16	54	152	V	<a href="#">136TA3860</a>	KOMATSU
12	B		58		16	54,5	152	V	<a href="#">128TA3932</a>	YALE
12	B		58		16	60	163	V	<a href="#">136TA3862</a>	TOYOTA
12	B		58,4		22	43	157	V	<a href="#">103TA3754</a>	TOYOTA
12	B		59,5		16	41,5	160	V	<a href="#">136TA3841</a>	HYUNDAI
12	B		71,5		36	52,5	151	V	<a href="#">105TA5599</a>	KALMAR
12	B		72		20	91	157	V	<a href="#">124TA6741</a>	TOYOTA
12	B		72		20		157	V	<a href="#">135TA1831</a>	TOYOTA
12	B		76		21		174	V	<a href="#">103TA3652</a>	HYSTER
12	B		76,5		13,5	45	175	V	<a href="#">128TA3718</a>	YALE
12	B		76,5		16	45	151	V	<a href="#">105TA5700</a>	MITSUBISHI-CATERPILLAR
12	B		78		20		180	V	<a href="#">136TA3815</a>	CLARK-SAMSUNG
12	B		80		15		150	V	<a href="#">136TA3793</a>	STILL
12	S		16,2		16	55	117,5		<a href="#">135TA1948</a>	BOBCAT
24	A	63	17	21,5	15		166		<a href="#">103TA3771</a>	OM PIMESPO
24	A	64	17	13,3	17	36,5	183	V	<a href="#">135TA1896</a>	OM PIMESPO
24	A	67	20	12	16	40	155	V	<a href="#">105TA5799</a>	TOYOTA
24	A	67	20	12	16	40	155	V	<a href="#">128TA3548</a>	TOYOTA
24	A	67	20,5	12,5	16	40	155	V	<a href="#">103TA3709</a>	TOYOTA
24	A	68	16	20	16	68	190	V	<a href="#">135TA1905</a>	KOMATSU
24	A	69,3	26,8	12	11		170	V	<a href="#">117TA8570</a>	KALMAR
24	A	70	13	24	16	76	225	V	<a href="#">135TA1909</a>	TCM
24	A	70	16	15,5	16	77	195	V	<a href="#">105TA5756</a>	TCM
24	A	70	16	16	16	76,5	196	V	<a href="#">107TA9465</a>	TCM
24	A	70	16	16,5	16	96	225	V	<a href="#">107TA9487</a>	TCM
24	A	70	16,3	16,3	15,7	78	213	V	<a href="#">136TA3853</a>	TCM
24	A	70,5	12	14	16	92,5	170	V	<a href="#">105TA5623</a>	KOMATSU
24	A	70,5	15,5	16,3	16,5	78,5	190		<a href="#">105TA5605</a>	KOMATSU
24	A	70,5	15,7	16,1	15,8	78,8	190	V	<a href="#">128TA3862</a>	KOMATSU
24	A	70,5	16	15,8	16,1	78	188,5	V	<a href="#">128TA3876</a>	KOMATSU
24	A	70,5	16	16	16	61,5	190	V	<a href="#">103TA3730</a>	KOMATSU
24	A	70,5	16	16	16	75	196		<a href="#">105TA5890</a>	TCM
24	A	70,5	16	16	16	75,5	224	V	<a href="#">135TA1758</a>	TCM
24	A	70,5	16	16	16	76	190	V	<a href="#">105TA5765</a>	TCM
24	A	70,5	16	16	16	76	190	V	<a href="#">105TA5755</a>	TCM
24	A	70,5	16	16	16	76	212	V	<a href="#">107TA9485</a>	TCM
24	A	70,5	16	16	16	88,6	190	V	<a href="#">105TA5607</a>	KOMATSU

# ALTERNATORS

For all our latest catalogue updates and company info: [www.tvh.com](http://www.tvh.com)

ALTERNATORS

## complete range

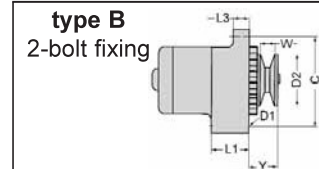
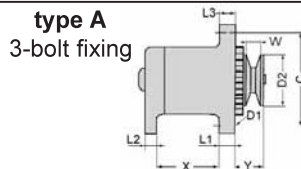

voltage (volt)	type	dimension (mm) X	dimension (mm) L1	dimension (mm) L2	dimension (mm) L3	dimension (mm) Y	dimension (mm) C	regulator REG	reference new	for picture see make
24	A	70,5	16	16	16	92,5	191		<a href="#">105TA5608</a>	KOMATSU
24	A	70,5	16	16,5	15	60,5	190	V	<a href="#">105TA5603</a>	KOMATSU
24	A	70,5	16,5	16	16,5	59	190	V	<a href="#">105TA5624</a>	KOMATSU
24	A	71	12	14	16	63,5	170	V	<a href="#">105TA5604</a>	KOMATSU
24	A	72	12	12	16	83	170	V	<a href="#">116TA7284</a>	TCM
24	A	75,5	12,2	12,3	12	48	168		<a href="#">107TA9505</a>	TOYOTA
24	A	75,5	15	12,5	15	45	170	V	<a href="#">107TA9553</a>	TOYOTA
24	A	75,8	12	11,4	12	49,3	168		<a href="#">128TA3699</a>	TOYOTA
24	A	76	12	12	12,5	47,5	167		<a href="#">105TA5808</a>	TOYOTA
24	A	78,5	13	16,5	13	55	175	V	<a href="#">136TA3872</a>	TCM
24	A	80	13	12,5	13	55,5	174	V	<a href="#">135TA1697</a>	YALE
24	A	80	13	13	13	38	175	V	<a href="#">124TA6716</a>	NISSAN
24	A	80	13	13	13	45,5	155		<a href="#">135TA1721</a>	NISSAN
24	A	80	13	13	13	54	155		<a href="#">128TA3471</a>	TCM
24	A	80	13	13	13	56,5	175	V	<a href="#">128TA3873</a>	NISSAN
24	A	80	13	13	13	57	174	V	<a href="#">103TA3625</a>	NISSAN
24	A	80	13	13	14	43	175	V	<a href="#">124TA6721</a>	NISSAN
24	A	80	13	13	14	46	174	V	<a href="#">128TA3836</a>	NISSAN
24	A	80	13	13	14	67,5	191	V	<a href="#">105TA5513</a>	NISSAN
24	A	80	13	18	14	55	190	V	<a href="#">135TA1906</a>	TCM
24	A	80	13	18	14	74	190	V	<a href="#">135TA1895</a>	NISSAN
24	A	80	13,5	13	13	42,5	156	V	<a href="#">107TA9501</a>	TCM
24	A	80	14	13	14	44	175	V	<a href="#">124TA6632</a>	NISSAN
24	A	80	14	14	14	60	175	V	<a href="#">128TA3627</a>	NISSAN
24	A	80	14	14	14	61	190	V	<a href="#">135TA1950</a>	NISSAN
24	A	80	14,5	13	14,5	38	155	V	<a href="#">128TA3926</a>	KOMATSU
24	A	80,1	13	16	14	61,5	190	V	<a href="#">116TA7380</a>	NISSAN
24	A	80,3	13	13	13	56	175		<a href="#">116TA7389</a>	NISSAN
24	A	80,3	13	13	13	57	175	V	<a href="#">124TA6711</a>	NISSAN
24	A	80,4	13	12,8	14,5	45	175	V	<a href="#">124TA6726</a>	NISSAN
24	A	80,5	13	11,7	13,3	56,4	175	V	<a href="#">124TA6731</a>	NISSAN
24	A	80,5	13	13	12	62	174		<a href="#">107TA9546</a>	NISSAN
24	A	80,5	13	16	14	63	190	V	<a href="#">116TA7390</a>	NISSAN
24	A	80,5	14,2	13,9	14,2	72	176	V	<a href="#">136TA3801</a>	NISSAN
24	A	80,5	14,8	13	14,6	37,5	155	V	<a href="#">105TA5766</a>	TCM
24	A	80,6	13	15,6	14	64	188	V	<a href="#">135TA1804</a>	NISSAN
24	A	80,7	13,2	16	14	62	190	V	<a href="#">124TA6690</a>	NISSAN
24	A	80,8	18,1	13	18,2	43	190	V	<a href="#">103TA3733</a>	NISSAN
24	A	81	13	13	14,5	44,5	175	V	<a href="#">124TA6575</a>	NISSAN
24	A	81	14	13,5	14	52	162,5	V	<a href="#">135TA2468</a>	NISSAN
24	A	81	14	16,5	13,5	56	175	V	<a href="#">135TA1927</a>	NISSAN
24	A	81	14,5	13	14,5	38	155	V	<a href="#">116TA7378</a>	KOMATSU
24	A	81	14,5	13	14,5	44	155	V	<a href="#">128TA3456</a>	NISSAN
24	A	81,5	13,5	13	14,2	44	189	V	<a href="#">116TA7340</a>	NISSAN
24	A	82	13	13	13	46,5	155	V	<a href="#">116TA7277</a>	TCM

# ALTERNATORS

For all our latest catalogue updates and company info: [www.tvh.com](http://www.tvh.com)



## complete range

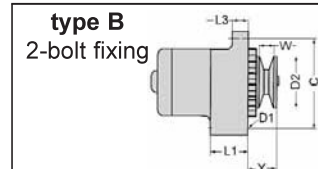
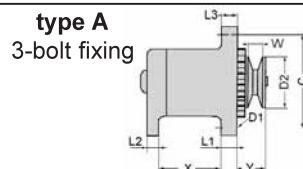

ALTERNATORS

voltage (volt)	type	dimension (mm) X	dimension (mm) L1	dimension (mm) L2	dimension (mm) L3	dimension (mm) Y	dimension (mm) C	regulator REG	reference new	for picture see make
24	A	82	13	13	13	54,5	175	V	<a href="#">128TA3900</a>	HYUNDAI
24	A	82	13	13	13	56	176	V	<a href="#">128TA3854</a>	NISSAN
24	A	82	14	14	14		159,6	V	<a href="#">135TA1792</a>	YALE
24	A	82,2	13	13	13	43	158,5	V	<a href="#">107TA9498</a>	KOMATSU
24	A	82,6	16,2	16	18,5	60,2	235	V	<a href="#">105TA5627</a>	KOMATSU
24	A	83,5	14	15	14		150		<a href="#">128TA3861</a>	KALMAR
24	A	83,5	14,5	15	14		148	V	<a href="#">135TA1870</a>	LINDE-LANSING
24	A	84	14	20	14,5		149	V	<a href="#">136TA3867</a>	KALMAR
24	A	86	14	14	14	68	220	V	<a href="#">103TA3791</a>	TOYOTA
24	A	86	14	14	14,2	67,5	222	V	<a href="#">128TA3687</a>	TCM
24	A	90	16	16	18,5	60	235	V	<a href="#">116TA7313</a>	NISSAN
24	A	90,3	15,8	16	18,4	80	234	V	<a href="#">105TA5629</a>	KOMATSU
24	A	90,3	24	16	24	121	233		<a href="#">105TA5628</a>	KOMATSU
24	A	90,5	16	16	18,5	80	235	V	<a href="#">105TA5630</a>	KOMATSU
24	A	90,5	16,5	16	18,5	61	235		<a href="#">128TA3906</a>	KOMATSU
24	A	96	14	14	14,2	48	175	V	<a href="#">110TA9055</a>	YALE
24	A	98	13	13	12,5	57	175	V	<a href="#">136TA3820</a>	mitsubishi-caterpillar
24	A	98	14	15,5	14	62	172	V	<a href="#">128TA3874</a>	mitsubishi-caterpillar
24	A	98,3	12,8	13	12,8	44	175	V	<a href="#">136TA3804</a>	OM PIMESPO
24	A	98,3	13	12,5	12,6	47	175	V	<a href="#">116TA7392</a>	mitsubishi-caterpillar
24	A	98,5	14	15,4	14	61	177	V	<a href="#">107TA9424</a>	mitsubishi-caterpillar
24	A	100,5	14,7	13	14,3		210	V	<a href="#">128TA3928</a>	LINDE-LANSING
24	A	101	14	13,5	14		198	V	<a href="#">124TA6704</a>	YALE
24	A	101	14	13,5	14		198	V	<a href="#">136TA3835</a>	YALE
24	A	101	14	14	14		197	V	<a href="#">124TA6616</a>	mitsubishi-caterpillar
24	A	101	14,5	13,3	15		210	V	<a href="#">128TA3842</a>	CLARK-SAMSUNG
24	A	101	14,5	14	14		198	V	<a href="#">136TA3864</a>	JCB
24	A	101,2	13,8	14	13,6	59	198,3	V	<a href="#">107TA9423</a>	mitsubishi-caterpillar
24	A	101,4	14	14	14		197		<a href="#">135TA1944</a>	mitsubishi-caterpillar
24	A	101,5	13,5	13,5	13,5		196	V	<a href="#">136TA3863</a>	mitsubishi-caterpillar
24	A	101,5	14	14	14		198,5	V	<a href="#">135TA1949</a>	HYSTER
24	A	101,5	14,5	13,5	14		199	V	<a href="#">124TA6614</a>	mitsubishi-caterpillar
24	A	101,5	14,5	13,5	14,5		197	V	<a href="#">128TA3817</a>	HYUNDAI
24	A	101,5	15	14	15		197	V	<a href="#">116TA7324</a>	HYUNDAI
24	A	102	14	14	14		197	V	<a href="#">136TA3833</a>	SVE TRUCK
24	A	102	14	14	14		198		<a href="#">105TA5519</a>	mitsubishi-caterpillar
24	A	102	14	14	14		198	V	<a href="#">135TA1933</a>	KOMATSU
24	A	102	15	16	15		196	V	<a href="#">105TA5518</a>	mitsubishi-caterpillar
24	A	102,6	16	16	16	61,6	200	V	<a href="#">105TA5625</a>	KOMATSU
24	A	103	16	15	16	74	200	V	<a href="#">124TA6633</a>	KOMATSU
24	A	103,8	14,5	14	14,5		198	V	<a href="#">135TA1842</a>	SVE TRUCK
24	A	105,4	14	15,2	14	79	174	V	<a href="#">105TA5793</a>	TOYOTA
24	A	105,5	14	15	14	48	177		<a href="#">103TA3790</a>	TOYOTA
24	A	105,5	14	15	14	64,5	174		<a href="#">103TA3752</a>	TOYOTA
24	A	105,5	14	15	14	78	175	V	<a href="#">128TA3888</a>	TOYOTA

